

Zamperla
"Truck Stop"
Kiddie

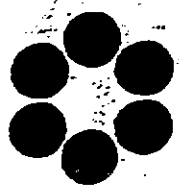

ZAMPERLA

AMUSEMENT RIDES MANUFACTURERS

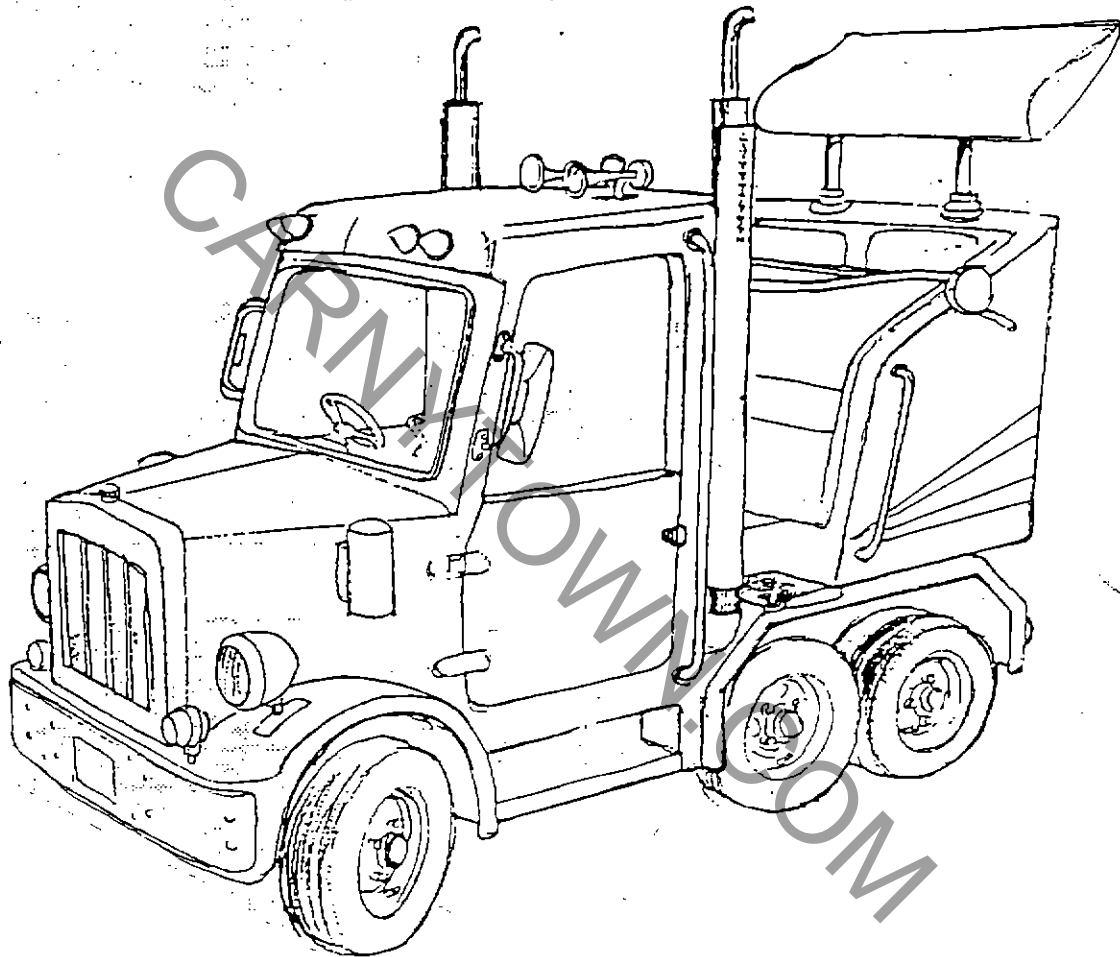

TRUCK STOP

INSTRUCTION FOR SETTING UP-MAINTENANCE

SPARE PARTS CATALOGUE

The descriptions and illustrations contained in the present publication are understood to be non-binding; ZAMPERLA INC. thus reserves the rights to effect, at any time and without prior commitment to bring the publication up-to-date, any such alterations to organs, component parts any accessory supplies as it may deem opportune for the purposes of improvement or in order to meet any demands of a constructional or commercial nature.

Le descrizioni ed illustrazioni contenute nella presente pubblicazione non s'intendono impegnative; la ZAMPERLA pertanto, si riserva il diritto di apportare in qualunque momento, senza impegnarsi ad aggiornare tempestivamente la pubblicazione, le eventuali modifiche ad organi, dettagli, forniture di accessori, che essa ritiene convenienti per un miglioramento o per qualsiasi esigenza di carattere costruttivo o commerciale.

ZAMPERLA INC.
AMUSEMENT RIDES MANUFACTURERS
U.S. OFFICE: 16 Rd. Brunswick N.J. 08816
ph. (201) 238-6280 - Tlx. 642286

A. ZAMPERLA S.r.l.
AMUSEMENT RIDES MANUFACTURES
Via Monte Grappa, 7
36100 ALTAVILLA VICENTINA - VI - ITALY
Tel. 0444 / 573133 (6 linee ric. aut.)
Telex 431088 ZAMPER I

TRUCK STOP

Instructions for set-up and tear-down of the trailer mounted Truck Stop.

WARNING! Before attempting to set up this ride, the following procedures should be read thoroughly and completely understood. If there are any questions, please contact the Zamperla technical service department at 1-800-888-8878.

DO NOT ASSEMBLE THE RIDE IF ANY ASPECT IS UNCLEAR OR PARTS ARE MISSING!

Set-up:

- 1) Locate trailer in an appropriate, level location with ample room using the supplied dimensions as a guide.
- 2) Unlock the ball hitch and pull the truck from under the ride, using the hydraulic jacks supplied to raise the ride. This system is energized by a key switch located on the hydraulic control box, which is mounted on the right side of the ride. (Each handle operates one corner of the ride).
WARNING: THE PUMP MUST BE OPERATING WHEN THE RIDE IS BEING RAISED AS WELL AS LOWERED.
- 3) Raise the ride until the riding wheels just clear the ground. At this time remove the large bolt and two pins on each side of the trailer which hold the axles and fenders in the riding position.
- 4) Unbolt the tongue/hitch section of the trailer by removing the three 'T' shaped bolts and the turnbuckle connecting the front car to the tongue. Swing the tongue out of the way of the track.
- 5) Lower the entire ride onto the ground after making sure that there are no wires or other obstructions underneath the ride.
- 6) Remove the track from its racked position on the top of the ride and assemble it in the general pattern outlined in the supplied drawings.
- 7) Loosly assemble the track on a level plane, making sure all the bolts are in place but not tightened. Once all the track is assembled, tighten all the bolts. Be sure that all the joints are flush with each other and that there are no large gaps between the joints.

- 8) Remove the fence from its racked position and place it around the ride at least three feet from the track at all points.
- 9) Remove racking pieces from the ride.
- 10) Remove ratchet ties from trucks.
- 11) Separate trucks and install spacer bars, being sure to notate the location of the riding spacer bars.
- 12) Connect ride to appropriate power source.
- 13) Inspect ride to assure proper set-up and condition of ride.
- 14) Run ride for at least one full cycle before operating with customers.

Tear down:

Reverse above procedure for tear-down of the ride.

CARNY TOWN.COM

Maintenance

Daily:

- 1) Make sure the track is level and check for loose connections and gaps in the rail.
- 2) Check safety belts and gates.
- 3) Check and replace burned out light bulbs.
- 4) Check position and condition of fence.

Weekly:

- 1) Check electrical connections on track and cars.
- 2) Check mechanical connections between cars.
- 3) Clean and wax cars

Monthly:

- 1) Check position of the guide bearing (TR-45 Tab.RG-2, RG-3) in relation to the inside rail. Adjust the spacer as necessary (it will change as the wheels wear).
- 2) Check wheels for wear and replace as necessary.
- 3) Check bushings (TR-29 Tab.RG-2, RG-3). Replace as necessary
- 4) Check motor brushes (TR-80 Tab.RG-2, RG-3, RG-5.1). Replace as necessary (when under 1/4" long).
- 5) Check tension of transmission chains (TR-73 Tab.RG-2, RG-5.1).
- 6) Check tension of cogged belts (TR-107 Tab.RG-2, RG-3)

Every 6 months:

- 1) Check cars and rail for wear.
- 2) Check fiberglass (seats, bodies ect.)

TAB. RG 0
TAV. Ed. 1-07/85

STANDARD TRACK
PERCORSO STANDARD



Capacity: 30 Children
Power: 3KW Single phase with neutral

CARNY TOWN . COM

32' With Fence

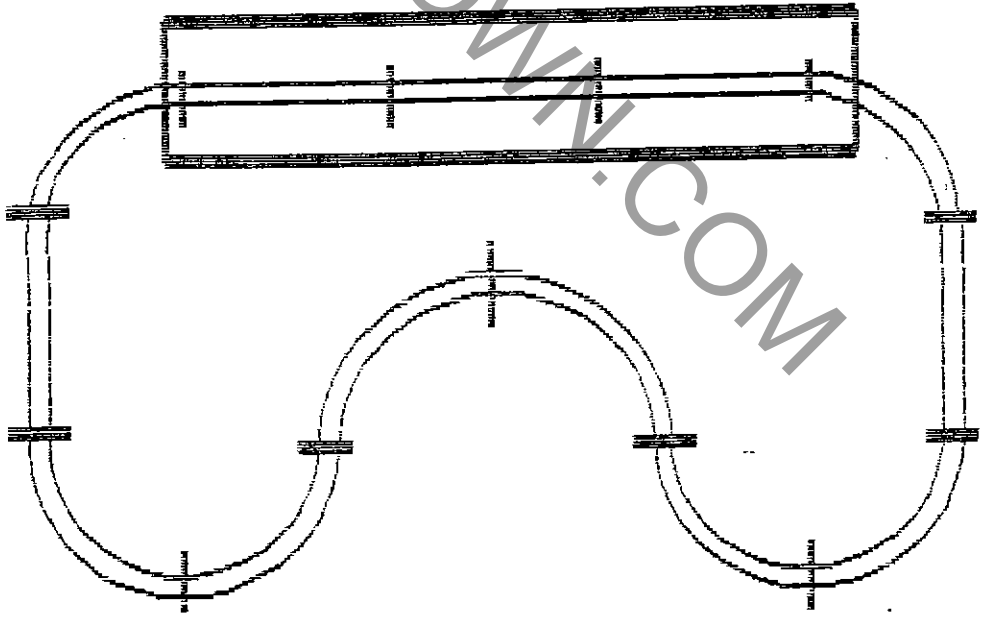

29'

44'

50' With Fence

SPARE PARTS CATALOG

This catalogue illustrates and describes spare parts for product **ZAMPERLA**.

How to order spare parts

In order to facilitate stock search operations and shipment of spare parts we would ask our customers to observe the following standard procedures, specifying:

- a) Ride model
- b) Quantity of parts required
- c) Reference number, description, number of table in which parts are listed together.
- d) Exact address and company status of the purchaser, complete with relevant address for delivery of the goods.
- e) Shipment method required. (If this item is not specified, **ZAMPERLA** reserves the right, at its own discretion, to use any such method as it may deem opportune).

CATALOGO RICAMBI

Il presente catalogo, illustra e descrive le parti di ricambio relativo al prodotto **ZAMPERLA**

Modalità di ordinazione

Per facilitare la ricerca di magazzino e la spedizione dei pezzi di ricambio si pregano vivamente i Sigg. Clienti di attenersi alle seguenti norme e specificare sempre:

- a) Modello della giostra
- b) Quantità e pezzi desiderati
- c) Numero di riferimento, denominazione, numero di tavola nella quale sono rappresentati
- d) Indirizzo esatto e ragione sociale del Committente; completato con l'eventuale recapito per la consegna della merce
- e) Mezzo di spedizione desiderato. (Nel caso questa voce non sia specificata, la Ditta **ZAMPERLA**, si riserva di usare a sua discrezione il mezzo più opportuno).

INDEX
INDICE

STANDARD TRACK PERCORSO STANDARD	RG0
RAILS ROTAIE	RG1
DRIVE AXLE ASSALE-MOTORIZZAZIONE	RG2
IDLE AXLE ASSALE FOLLE	RG3
ELECTRICAL PANEL PANNELLO ELETTRICO	RG4
LOCOMOTIVE LOCOMOTIVA	RG5
IDLE DRIVE MOTORIZZAZIONE FOLLE	RG5.1
TENDER VAGONE CARBONE	RG6
PASSENGER WAGON VAGONE PASSEGGERI	RG7
GOODS WAGON VAGONE MERCI	RG8
ELECTRICAL BOARD QUADRO ELETTRICO	RG9

**SPARE PART LIST
LISTA RICAMBI**

POS.	DESCRIPTION	DESCRIZIONE
TR 3	RAIL INSULATOR	GIUNTO ISOLANTE
TR 4	M12 NUT	DADO M12
TR 5	WASHER	RONDELLA
TR 6	M12 x 25 SCREW	VITE M12 x 25
TR 27	M20 LOCKING NUT	DADO ESAGONALE AUTOBLOCCANTE M20
TR 29	NYLON BUSHING	BOCCOLA NYLON
TR 30	SKF 6203-2RS BEARING	CUSCINETTO A SFERE SKF 6203-2RS
TR 32	LOCKING NUT M10	DADO ESAGONALE AUTOBLOCCANTE M10
TR 33	WHEELS	RUOTE
TR 43	NYLON BUSHING	BOCCOLA NYLON
TR 45	SKF 6303-2RS BEARING	CUSCINETTO A SFERE SKF 6303-2RS
TR 47	M6 x 15 T.S. SCREW	VITE T.S. M6 x 15
TR 53	RIGHT SIDE MOTOR	MOTORE LATO DESTRO
TR 59	36L 050 COGGED PULLEY	PULEGGIA DENTATA TIPO 36L 050
TR 60	NYLON BUSHING	BOCCOLA NYLON
TR 63	PINION Z=9, P=3/8"	PERNO DENTATO Z=9 P=3/8"
TR 64	LEFT SIDE MOTOR	MOTORE LATO SINISTRO
TR 66	10L 050F COGGED PINION	ROCCHETTO DENTATO TIPO 10L 050F
TR 67	M8 x 30 T.T. SCREW	VITE T.T. M8 x 30
TR 72	RING GEAR Z=42, P=3/8"	CORONA DENTATA Z=42 P=3/8"
TR 73	P=3/8" CHAIN	CATENA P=3/8"
TR 78	BOBBINS	STATORE
TR 79	PLATE	PIATTO PORTA SPESSORE
TR 80	MOTOR BRUSH	SPAZZOLA
TR 81	6200-2Z BEARING	CUSCINETTO 6200-2Z
TR 82	ARMATURE	ROTORE
RG 101	CROSSING PLATE	PIASTRA DI SCAMBIO
RG 102	SHORT RAIL	BINARIO CORTO
RG 103	STRAIGHT RAIL	BINARIO DIRITTO
RG 104	CURVED RAIL	BINARIO CURVO
RG 105	PIN	PERNO
RG 106	SKF 6004-2RS BEARING	CUSCINETTO A SFERE SKF 6004-2RS
RG 107	COGGED BELT 255 L050	CINGHIA DENTATA TIPO 255 L050
*RG 108	S 181 No. 28 (25A/15A) HEADCAR CIRCUIT BREAKER	INTERRUTTORE AUTOMATICO S 181 n° 28 (25A/15A)
RG 109	IR 70 HF 40 DIODE (40 Amp.)	DIODO IR 70 HF 40 (40 A)
RG 110	PROTECTION	PARASASSI
RG 111	FIBERGLASS WHEEL	RUOTE IN RESINA
RG 112	FIBERGLASS HEADLIGHT	CORPO FANALE IN RESINA
RG 113	HEADLIGHT SUPPORT	SUPPORTO FANALE
RG 114	24V 35W B13 BULB	LAMPADINA 24V 35W B13
RG 115	HEADLIGHT	FARO
RG 116	GEAR RIN	GHIERA
RG 117	BELL ASSEMBLY	GRUPPO CAMPANA
RG 118	HANDLE	MANIGLIA
RG 119	NYLON BUSHING	BOCCOLE NYLON
RG 120	ROD	ASTA
RG 121	PIN	PERNO
RG 122	BRACHET	SUPPORTO
RG 123	BELL Ø 135	CAMPANA Ø 135
RG 124	CABEL STOPPER	FERMA CORDA
RG 125	EYE	OCCHIELLO

POS.	DESCRIPTION	DESCRIZIONE
RG 126	LIGHT ARIC ART. 33.924.000.B	FANALINO ARIC ART. 33.924.000.B
RG 127	24V 5W TORPEDO BULB	LAMPADINA SILURO 24V 5W 10x39
RG 128	"FURNACE" LAMPHOLDER	PORTALAMPADA CALDAIA PDF 23/0026 NORMALE SIEM
RG 129	PDF 23/0025 NORMAL-LANTER LAMPHOLDER	PORTALAMPADA LANTERNA TIPO PDF 23/0025 NORMALE CH
RG 130	SIGNALUX 24V BULB	LAMPADINA SIGNALUX 24V
RG 131	HAND RAIL	RINGHIERA
RG 132	ROD	TIMONE DI TRAINO
RG 133	SPACER	DISTANZIALE
RG 134	PIN	SPINA
RG 135	KEY	COPIGLIA A MOLLA
RG 136	BUMPER	RESPINGENTE
RG 137	NYLON BUSHING	BOCCOLA NYLON
RG 138	PIN	PERNO
RG 139	FORK	FORCELLA
RG 140	6000-2RS BEARING	CUSCINETTO 6000-2RS
RG 141	KEY RING	ANELLO ELASTICO
RG 142	6201-2RS BEARING	CUSCINETTO 6201-2RS
RG 143	NYLON BUSHING	BOCCOLA NYLON
RG 144	WHEEL BUSHING	BUSSOLA BLOCCARUOTE
RG 145	WHEEL SUPPORT	SUPPORTO RUOTA
RG 146	SY 20 TF SUPPORT	SUPPORTO SY 20 TF
RG 147	CHAIN CROWN Z = 55, P = 3/8"	CRONA PER CATENA Z = 55 P = 3/8"
RG 148	AXLE	ASSALE
RG 149	CHAIN PINION Z = 20, P = 3/8"	PIGNONE PER CATENA Z = 20 P = 3/8"
RG 150	CHAIN TENSIONER	TENDICATENA
RG 151	6201-2RS BEARING	CUSCINETTO 6201-2RS
RG 152	KEY RING	ANELLO ELASTICO
RG 153	210 L 050 COGGED BELT	CINGHIA DENTATA TIPO 210 L 050
RG 154	48 L 050 COGGED PULLEY	PULEGGIA DENTATA TIPO 48 L 050
■ RG 156	MICRO-SWITCH, CROUZET 83718	MICROCONTATTO CROUZET 83718
■ RG 157	SUPPORT FOR MICRO	SUPPORTO PER MICRO
■ RG 158	TIMER	TEMPORIZZATORE
▲ RG 159	MAIN SWITCH, 43 A	INTERUTTORE GENERALE, 43 A
RG 160	RELAY LC1D403	TELERUTTORE LC1D403
RG 160A	RELAY COIL	BOBINA TELERUTTORE
● RG 161	AUXILIARY TRANSFORMER, 75 W	TRASFORMATORE AUSILIARIO 75 W
● RG 162	POWER TRANSFORMER 5 KW	TRASFORMATORE DI POTENZA 5 KW
RG 163	SPEED SELECTOR, BREMAS 75 A	SELETTORE VELOCITA, BREMAS 75 A
RG 164	DIODE 400 V-150 A, ANODE GATE	DIODO 400 V-150 A, ANODO AL GATE
RG 165	PUSH PANEL	PULSANTIERA

- * SPECIFY IF WAGON OR AMPERAGE/SPECIFICARE VAGONE O AMPERAGGIO
- VERSION WITH AUTOMATIC STOP ONLY/SOLO SU VERSIONE CON FERMATA AUTOMATICA
- ▲ SPECIFY AMPERAGE/SPECIFICARE AMPERAGGIO
- SPECIFY TENSION/SPECIFICARE TENSIONE

POS. DESCRIPTION

TS07-01	Running Light Complete
TS07-01A	Running Light Cap
TS07-01B	Bulb
TS07-02	Smoke Stack
TS07-03	Horns
TS07-04	Hubcap
TS07-05	Complete Rim/Tire Assymblly
TS07-05A	Rim
TS07-05B	Tire
TS07-05C	Tube
TS07-06	Tail Light Complete
TS07-06A	Red Lens Cover
TS07-06B	Yellow Lens Cover
TS07-06C	Bulb
TS07-07	Bell
TS07-08	Rear View Mirror
TS07-09	Front Signal Light(top)
TS07-09A	Bulb
TS07-10	Front Signal Light(bottom)
TS07-10A	Bulb
SB-025	Seat Belt

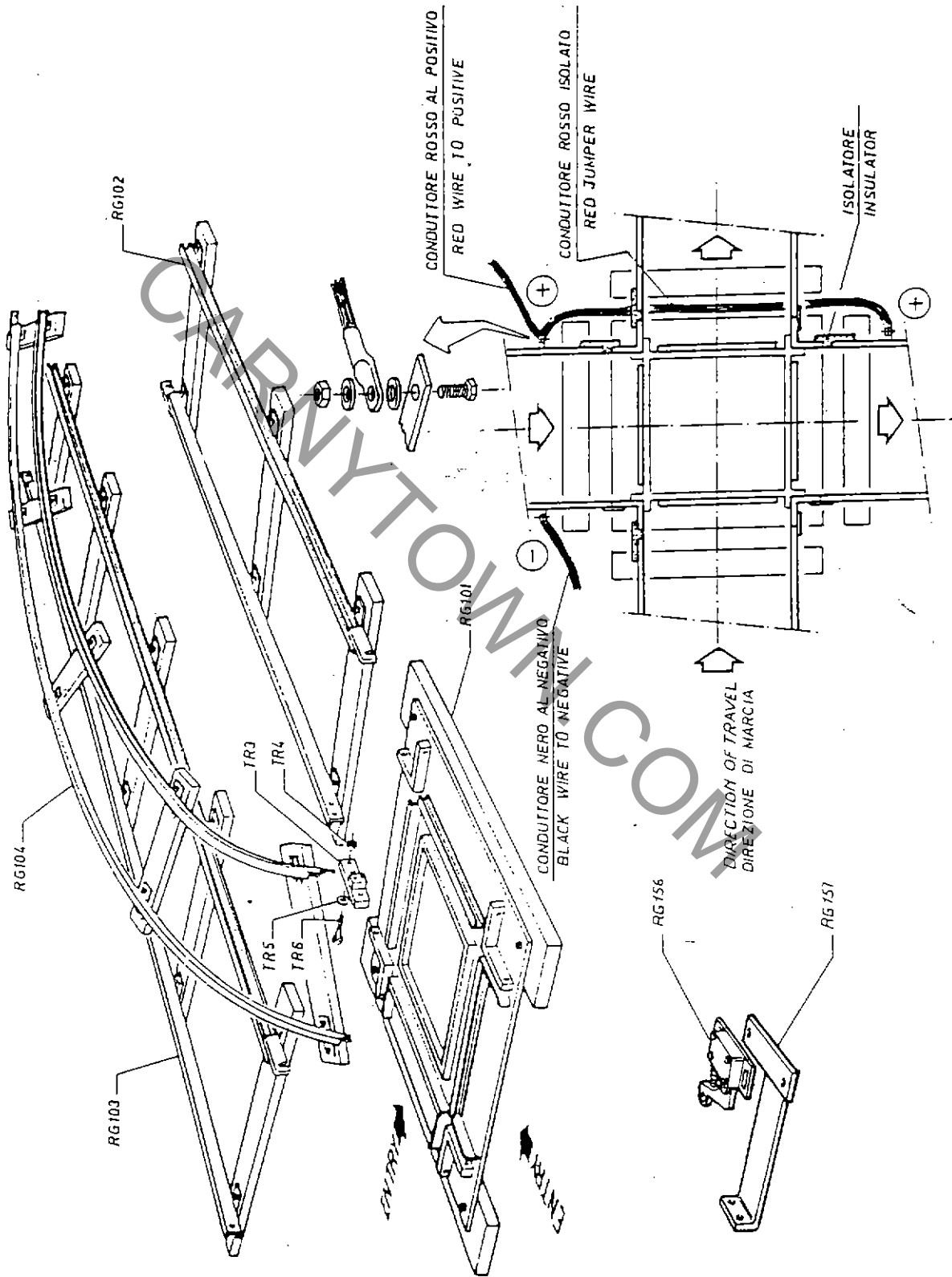

TAB. RG 2
TAV. RG 2

Ed. 1-07/85

DRIVE AXLE
ASSALE MOTORIZZAZIONE

ZAMPERLA
AMUSEMENT RIDES MANUFACTURERS

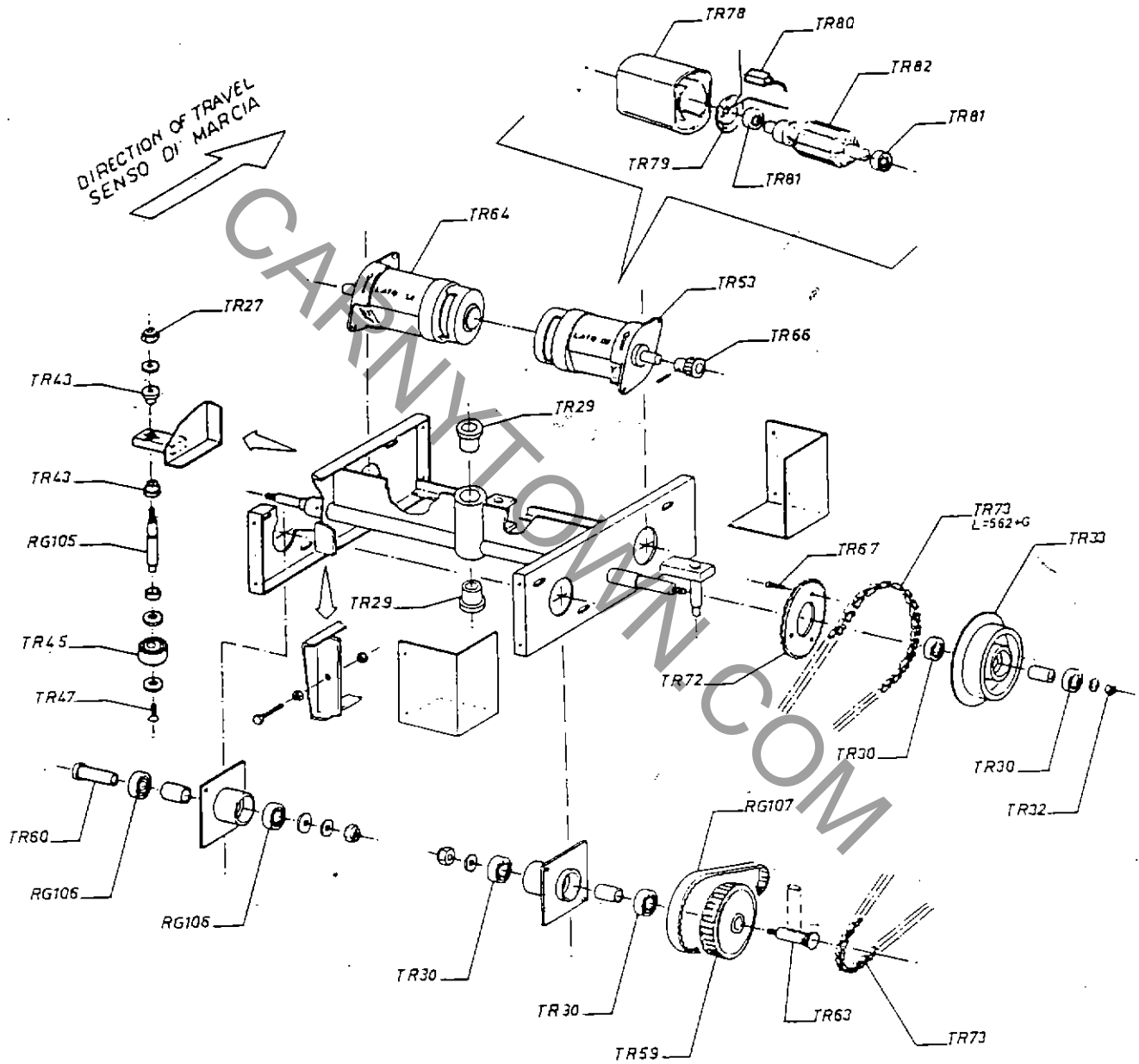

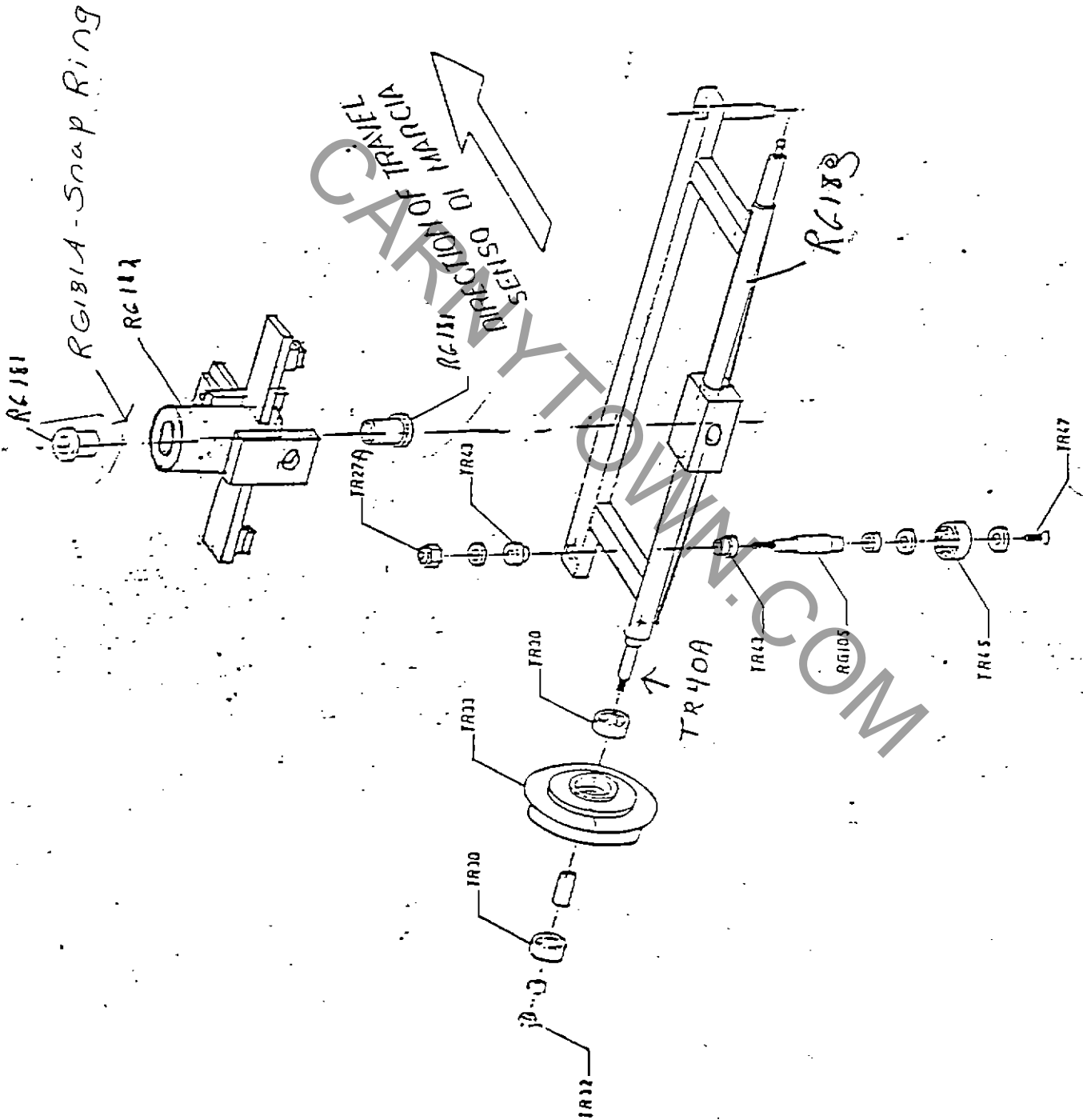

TAB. RG 4
TAV.

Ed. 1-07/85

ELECTRICAL PANEL
PANNELLO ELETTRICO

ZAMPERLA
AMUSEMENT RIDES MANUFACTURERS

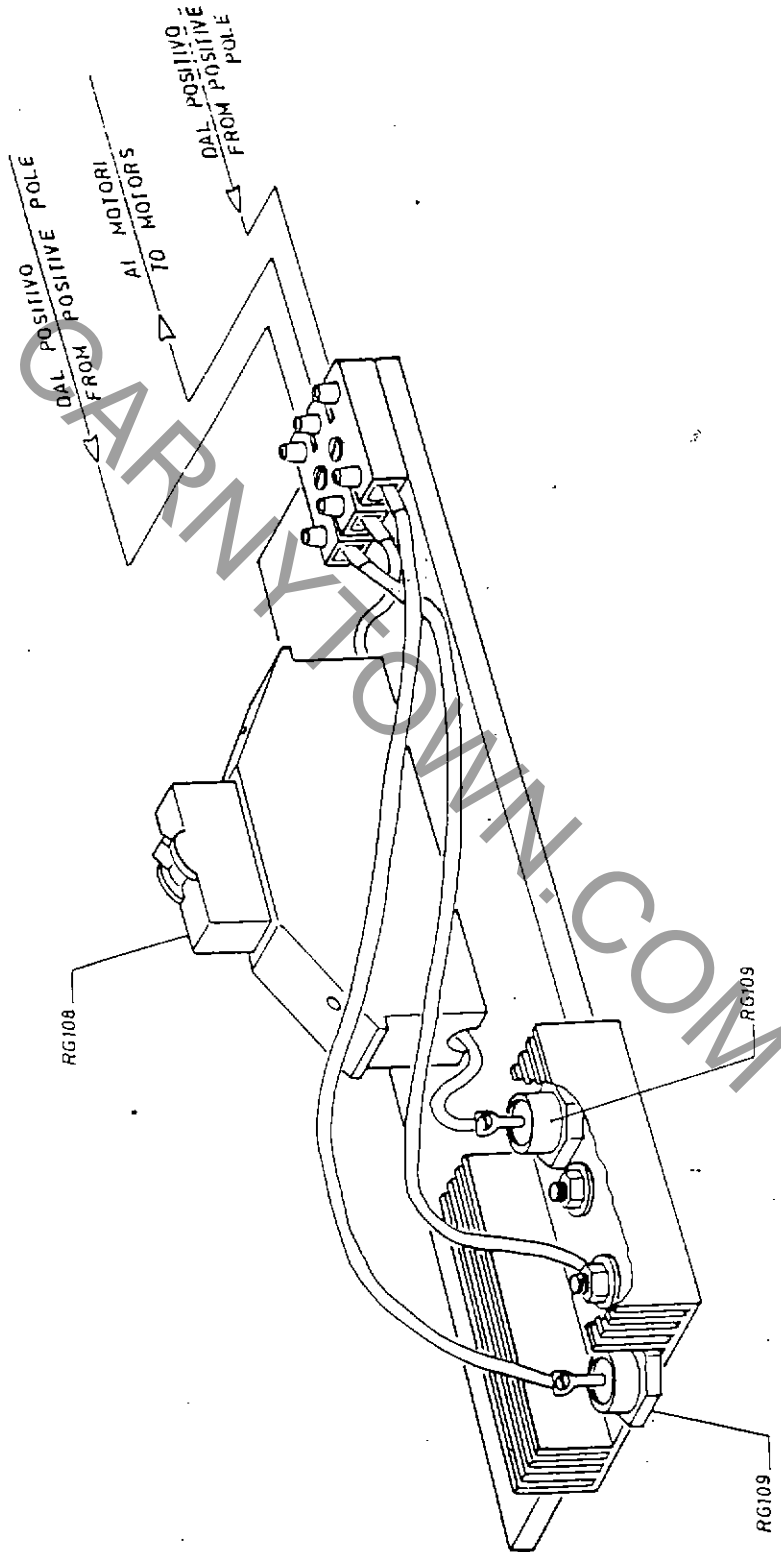

TAB. TS07
TAV. Ed. 1-07/85

PASSENGER WAGON
VAGONE PASSEGGERI

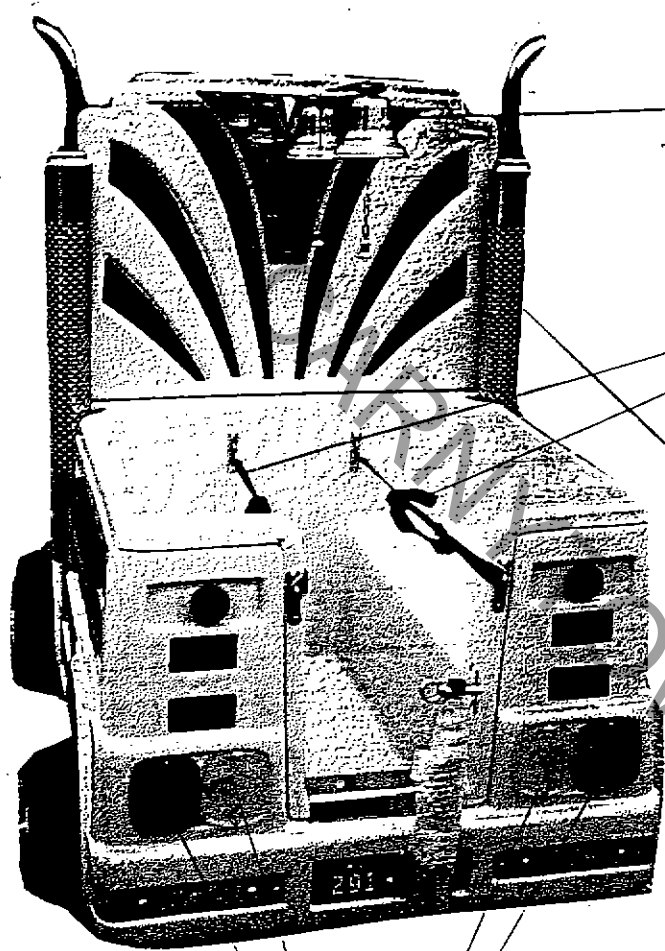

TS07-07

SB-025

TS07-02

TS07-08

TS07-06

TS07-09

TS07-05

TS07-10

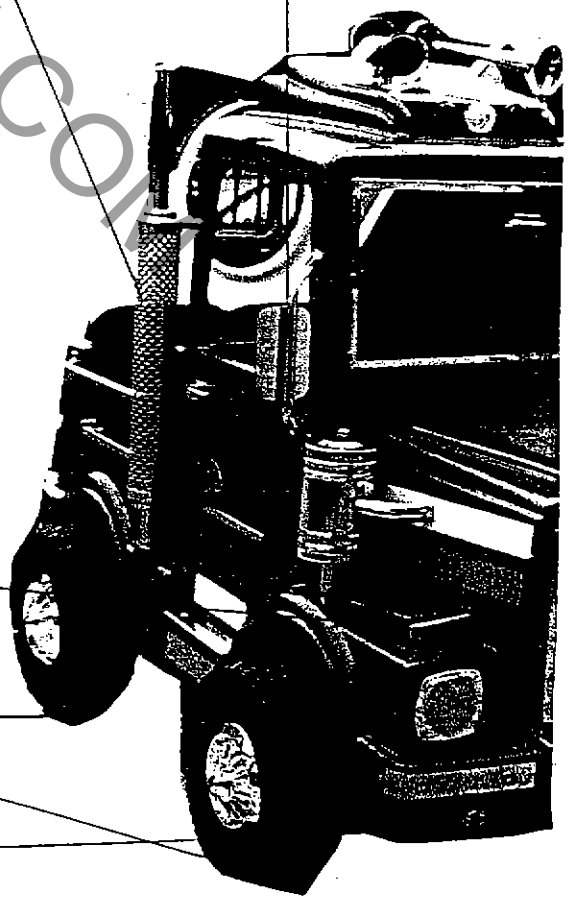

TAB. TS07
ITAV. Ed. 1-07785

PASSENGER WAGON
VAGONE PASSEGGERI

 **ZAMPERLA**
AMUSEMENT RIDES MANUFACTURERS

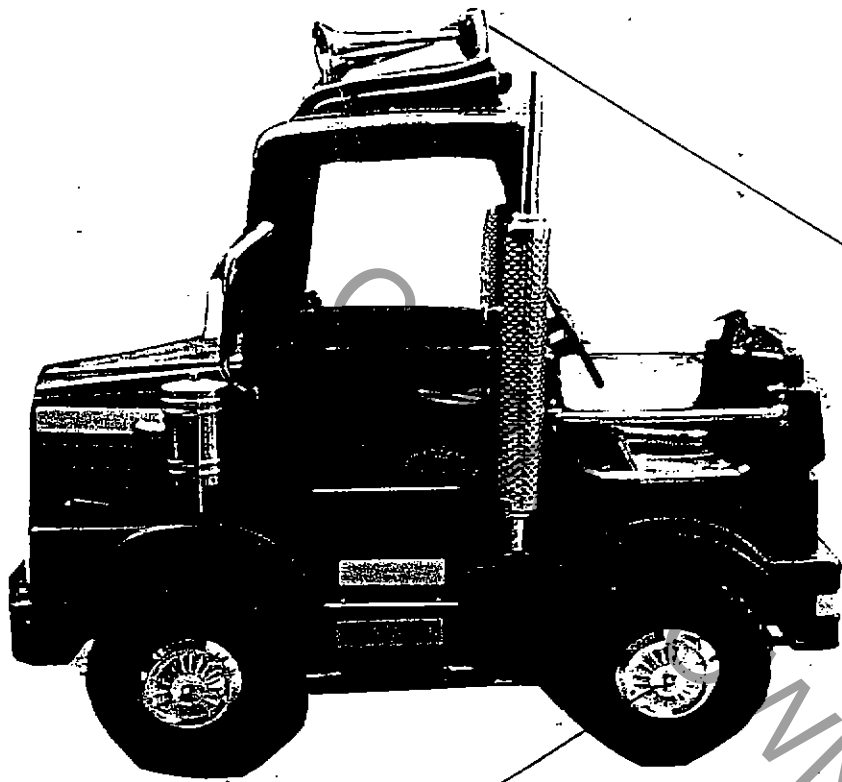

TS07-03

TS07-04

TS07-01

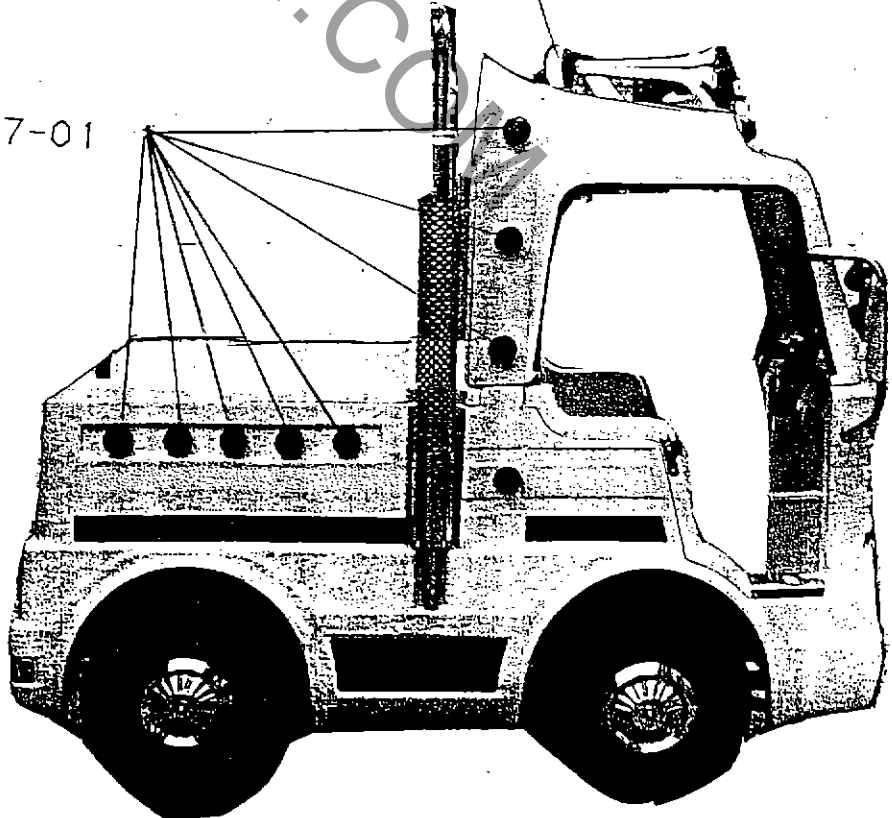

**LOGIC DIAGRAM
SCHEMA ELETTRICO**

CARNYTTOWN.COM

ZAMPERLA Inc.

DATE	Pg. of
SCALE	DWG. BY

R10 GRANDE POWER BOY TRAILER MOUNTED

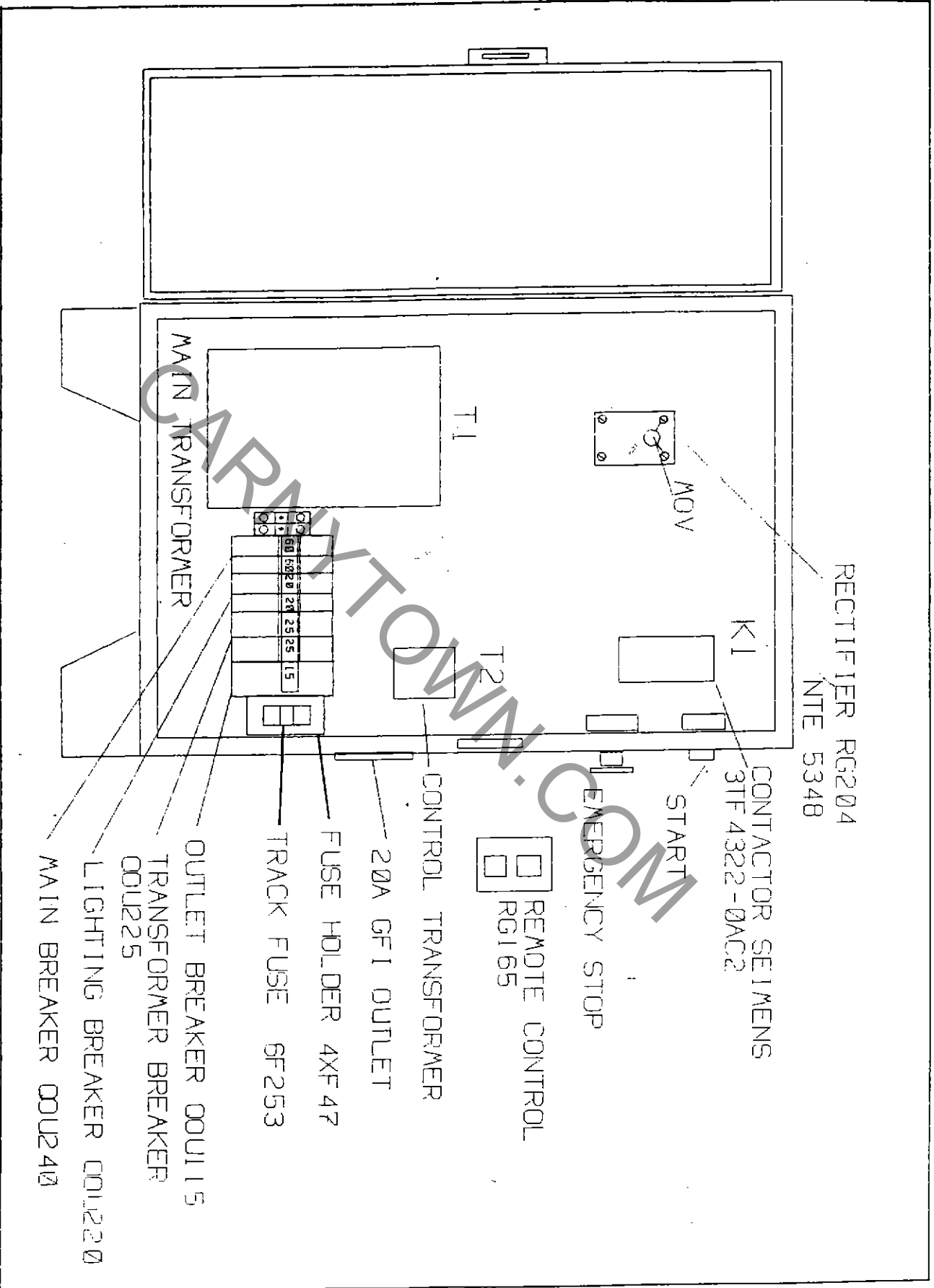

RECTIFIER RG204
NTE 5348

CONTACTOR SEIMENS
3TF 4322-0AC2

START
EMERGENCY STOP

REMOTE CONTROL
RG165

CONTROL TRANSFORMER

20A GFI OUTLET

FUSE HOLDER 4XF 47

TRACK FUSE 6F253

OUTLET BREAKER 00U115

TRANSFORMER BREAKER
00U225

LIGHTING BREAKER 00U220

MAIN BREAKER 00U240

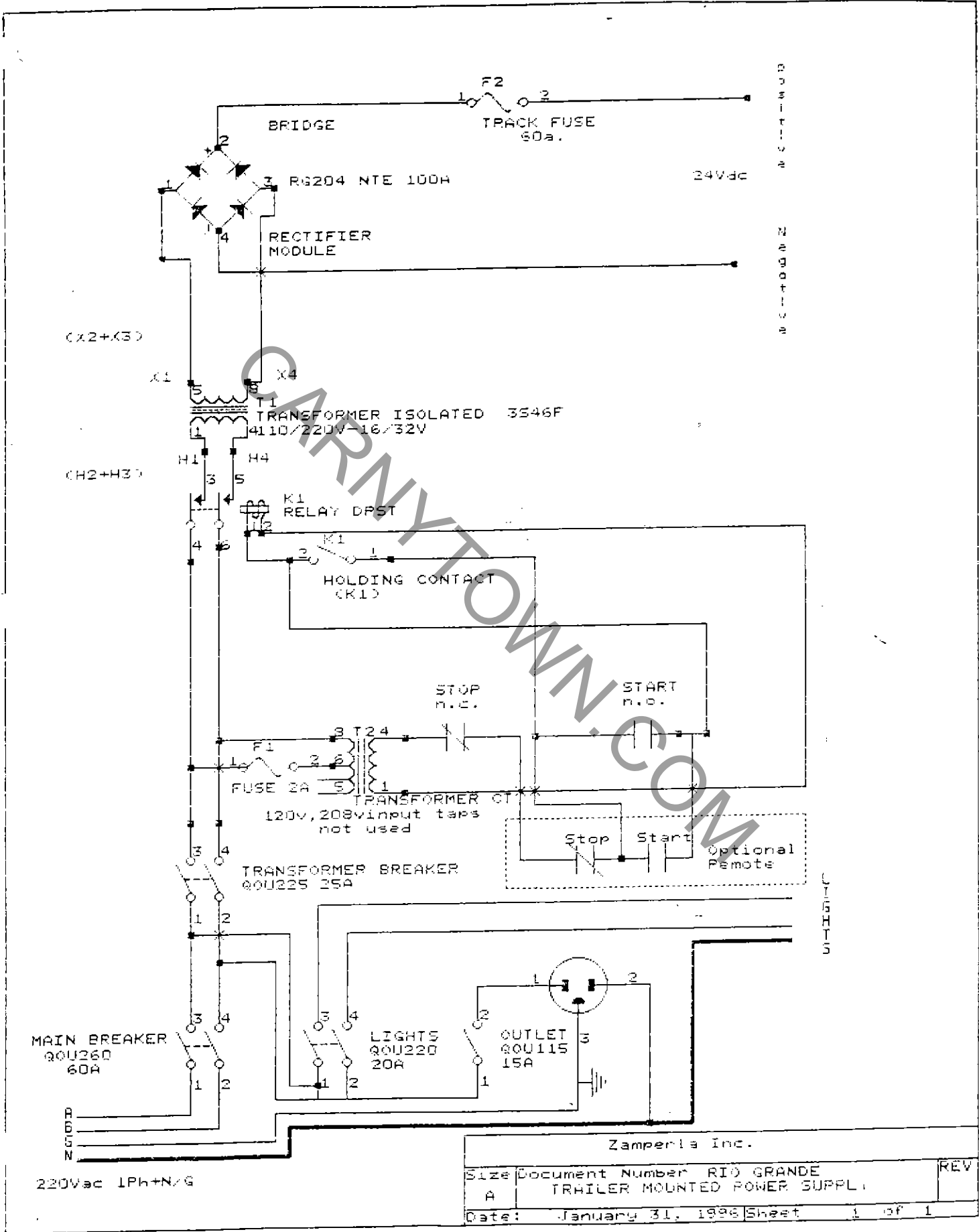

Zamperla Inc.		
Size A	Document Number RIO GRANDE TRAILER MOUNTED POWER SUPPLY	REV
Date:	January 31, 1996	Sheet 1 of 1