

MECHANICAL DRAWING FOR
WESTERN EXPRESS WAGONS

1	Screw 6X15
2	Washer
3	Nylon Wheel
4	Bearing 62303 17X40X19
5	Pin
6	Remote Control
7	Bearing 6003 17X35X10
8	Nylon Wheel
9	Remote Control
10	Bearing 6003 17X35X10
11	Washer
12	Nut
13	Bearing 62303 17X40X19
14	Pin
15	Remote Control
16	Washer
17	Nylon Bushing
18	Wheel Support
19	Nut
20	Washer
21	Nylon Bushing
22	
23	Thrust Bearing 80X105X6
24	
25	Washer
26	Nut
27	Wagon Juncture
28	Screw
29	Screw
30	
31	Thrust bearing 51104 20X35X11
32	
33	Nut
34	Electric Cable
35	Male Plugs Members
36	Iron Frame
37	Aluminum Step Plate
38	Aluminum Platform
39	Safety Handle
40	Pole Roof
41	Side Lamp
42	Bayonet Bulb
43	Lamp Holder
44	Fiberglass Roof
45	Plugs Members
46	Bulb Holder
47	Bayonet Bulb
48	Red Back Lamp
49	Fiberglass Body

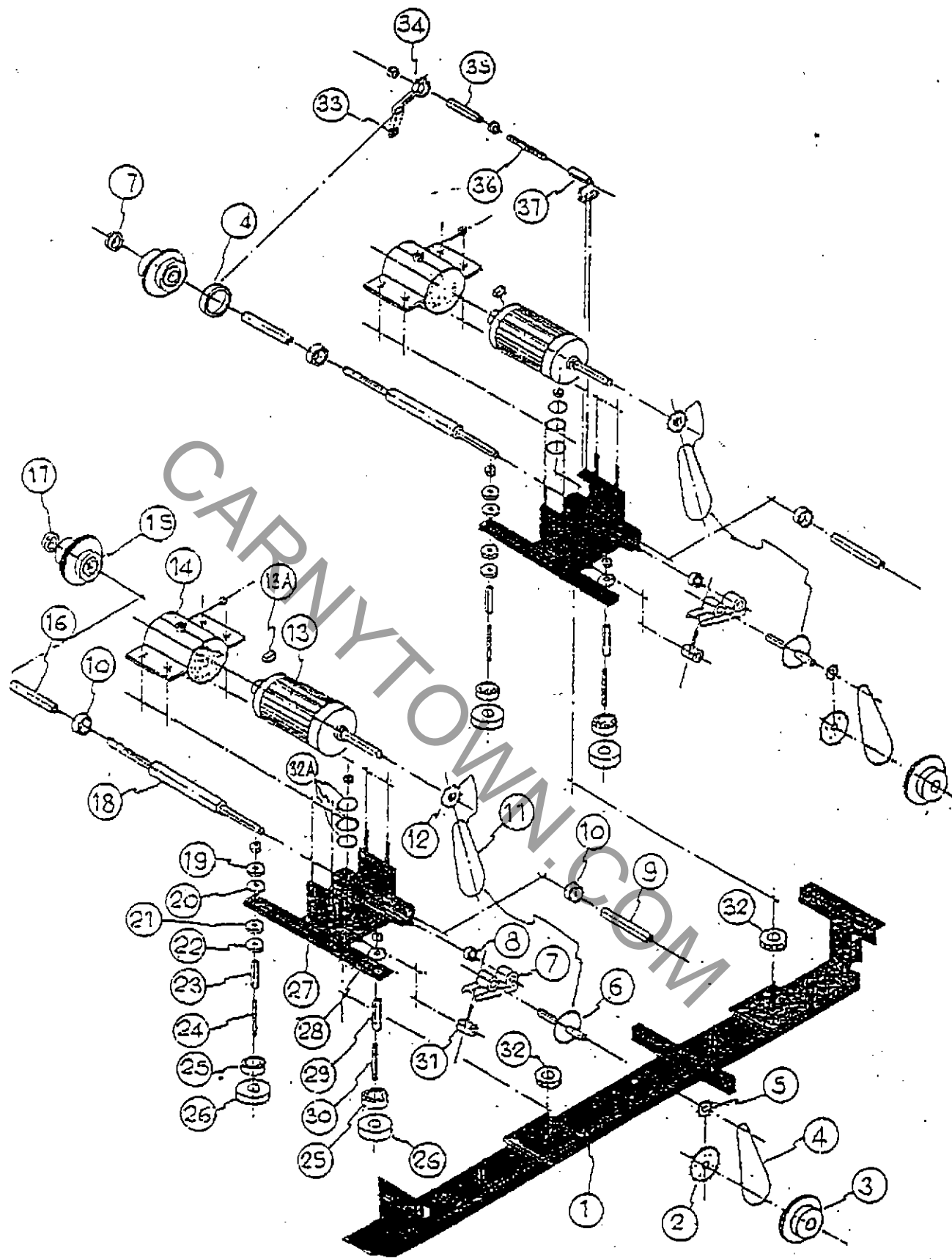

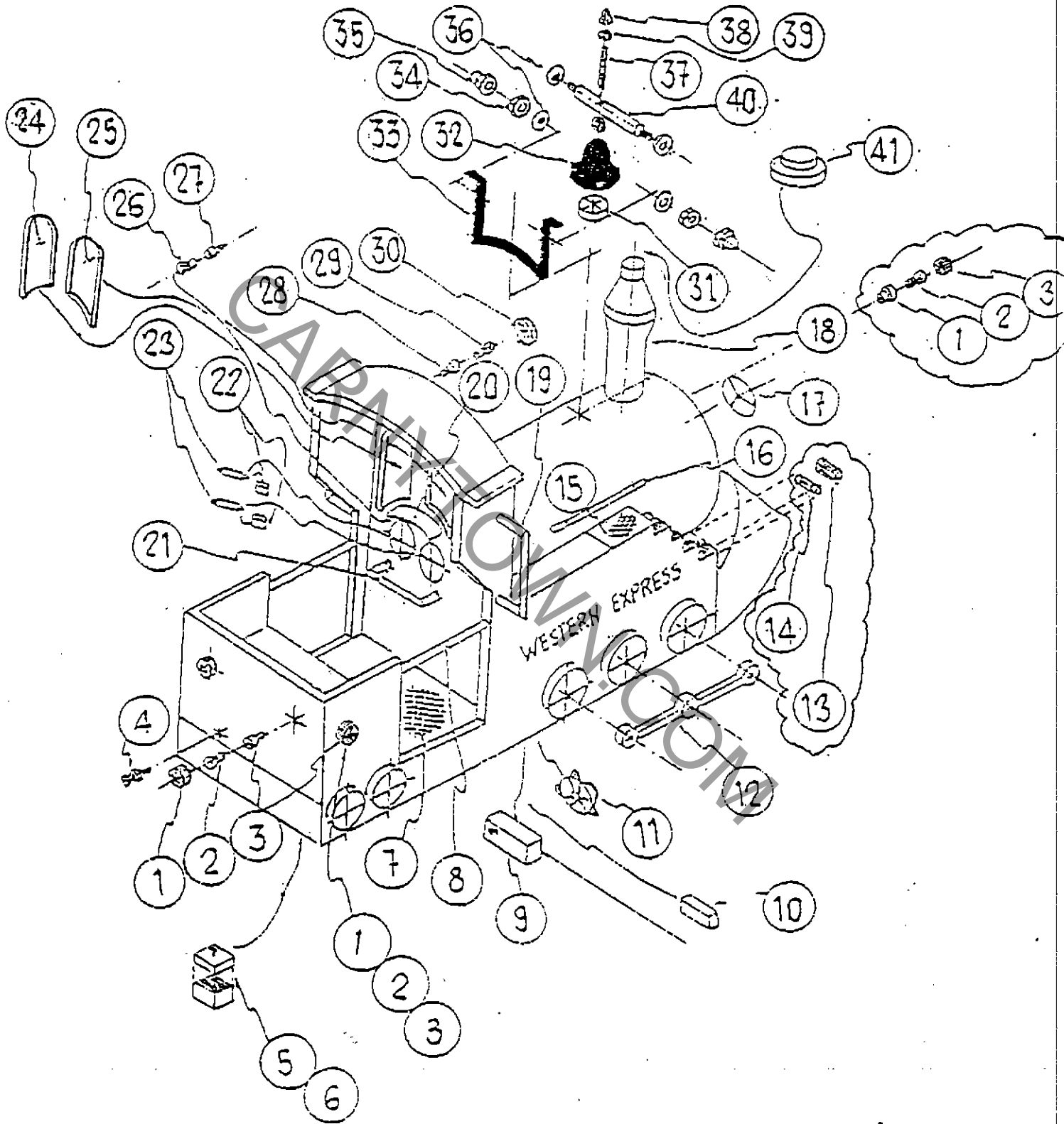

- REMOTE CONTROL 24 V
- MAIN SWITCH
- LAMP
- TRANSFORMER 220 or 110 V
- SPEED COMMUTATOR
- STARTING BUTTON
- STOP
- BELL BUTTON 12 V
- TRANSFORMER 2000 W or 2500
- BELL 12 V
- FUSES 32 AMP
- RECTIFIER
- VOLTMETER
- TIMER
- TRACK SWITCH

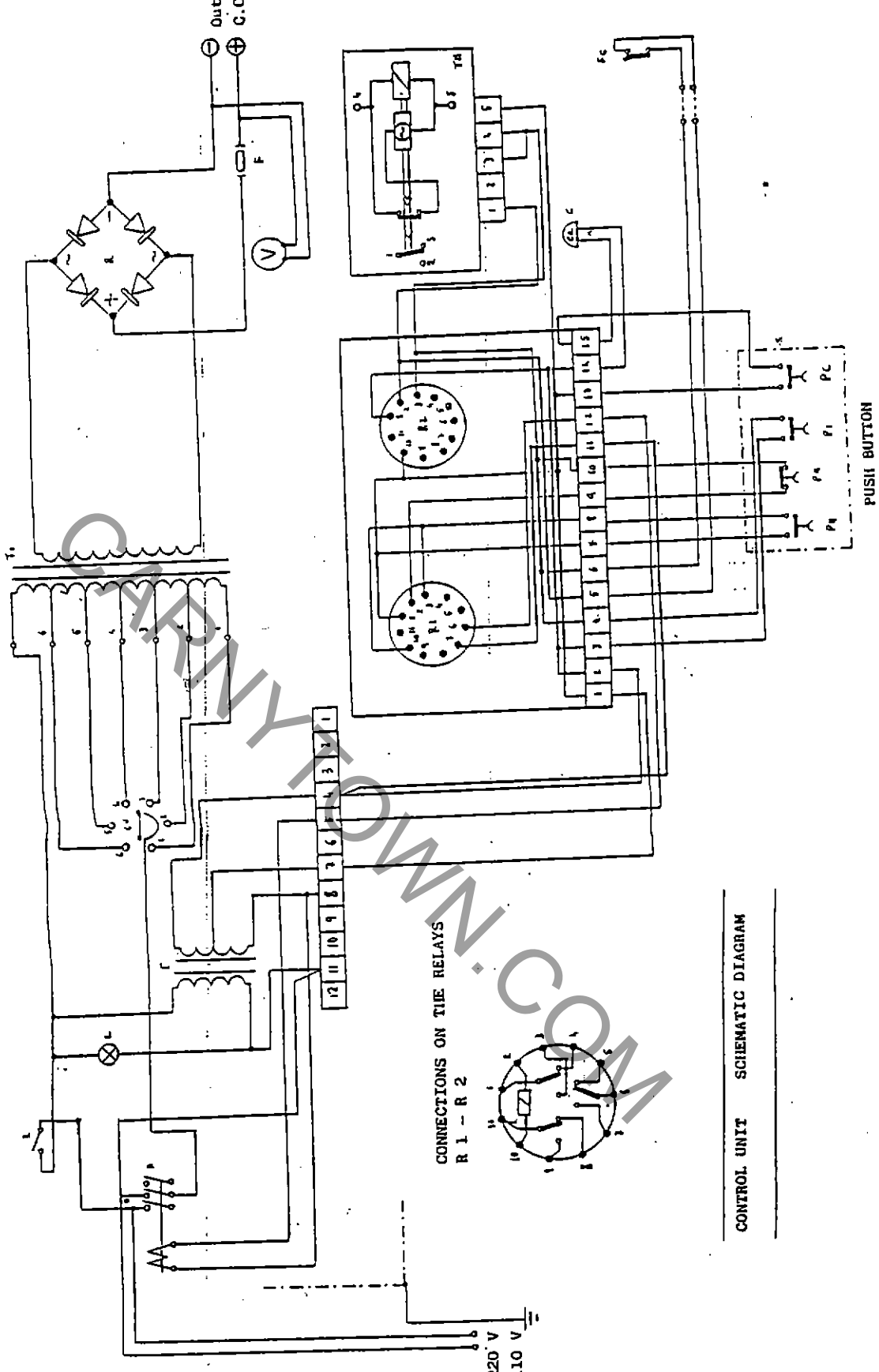

CONNECTIONS ON THE RELAYS
R 1 - R 2



CONTROL UNIT SCHEMATIC DIAGRAM

PUSH BUTTON

220 V
or 110 V

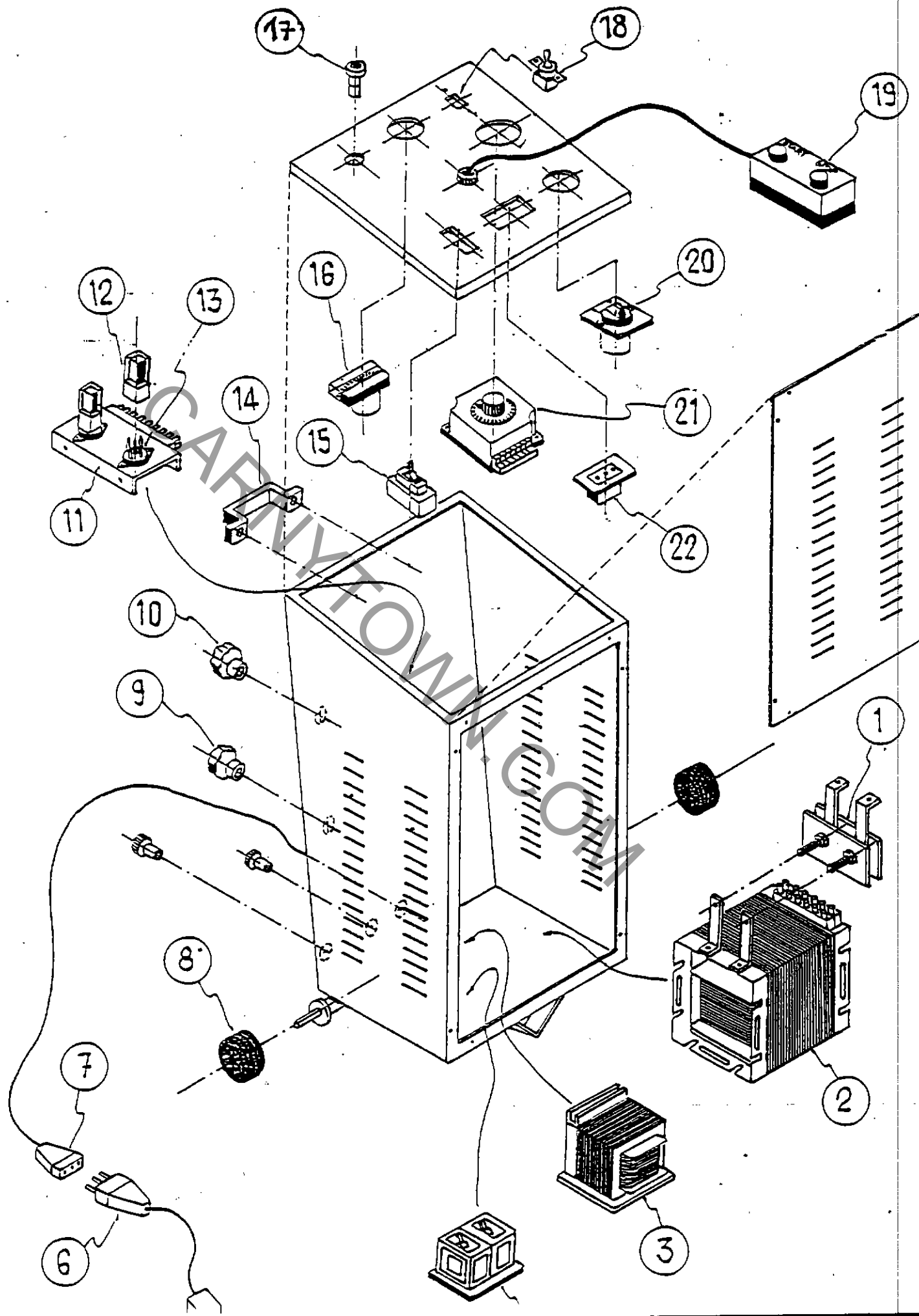

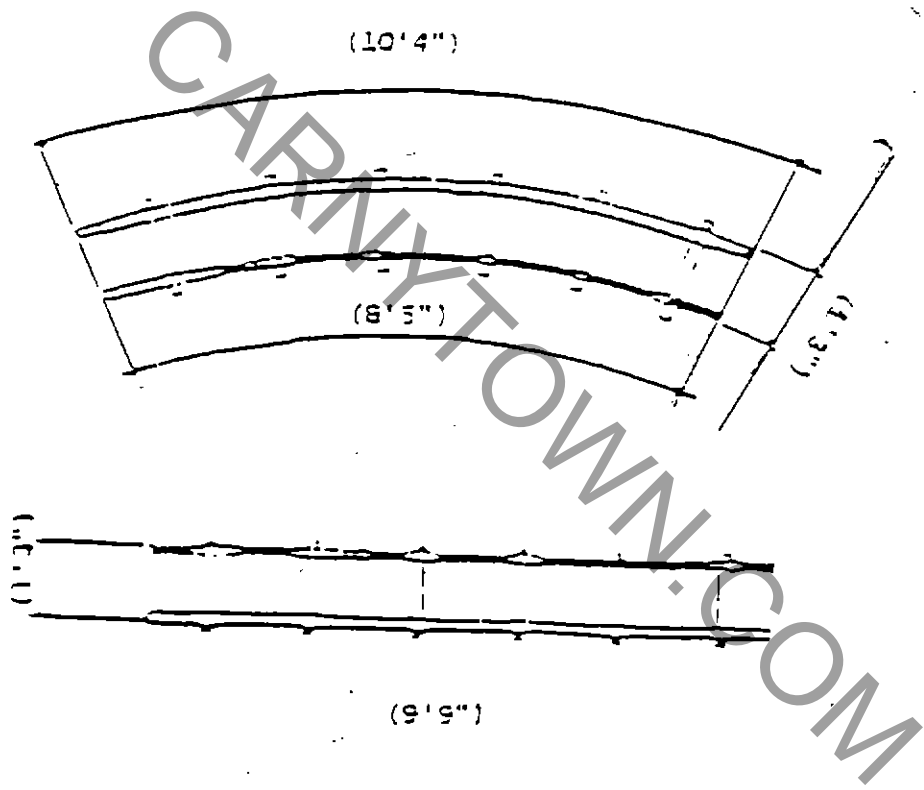

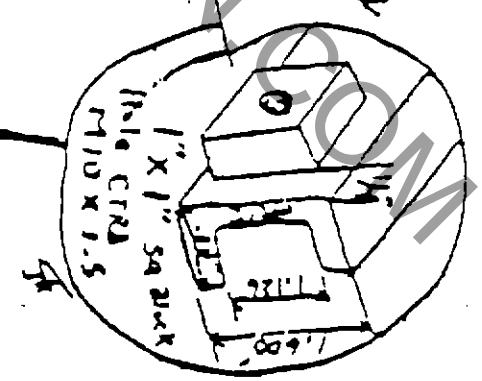
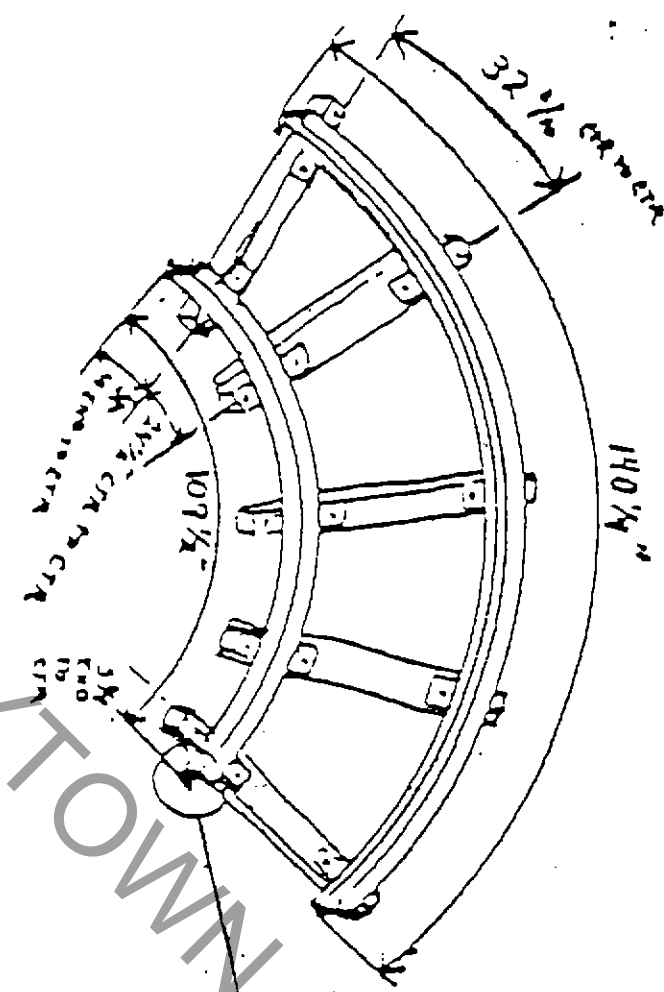
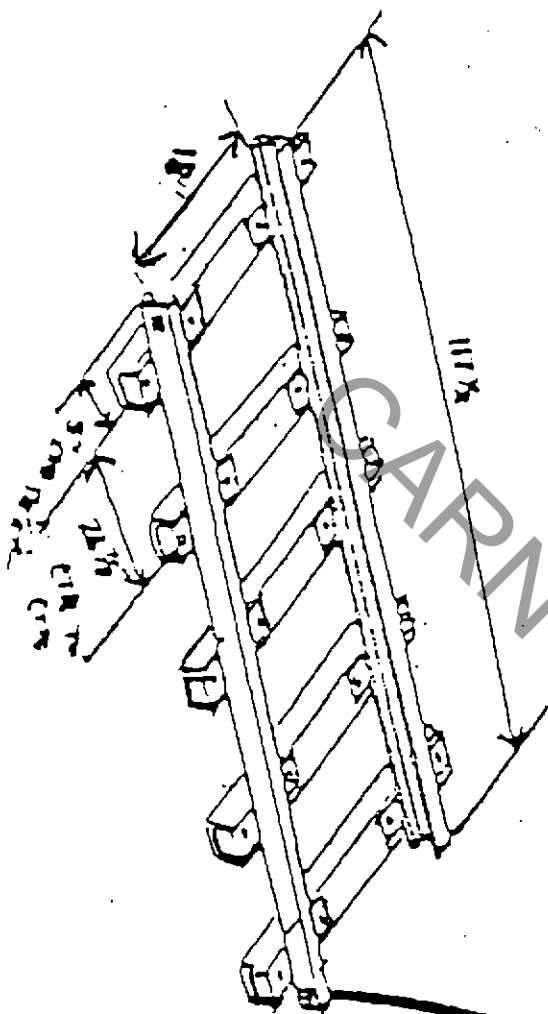

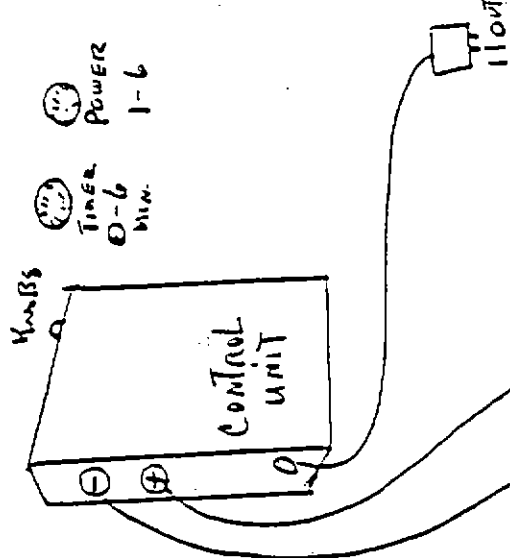

WIRE UNDER TRACK

⊖
 Neg.
 ⊕
 Pos.

CARNYTOWN.COM

Hook Bolt
 Bolt

Hook Bolt
 Bolt

Together
 Tighten with

DATE : .08

QUALITY CONTROL REPORT

FERTILIZER PLANT

CUSTOMER : KIDGIE BIDE U.S.A
 ATTN : MR. STEWART J. HELLER

PRODUCT : FERTIC 147 - 2400

ORDER No. FROM OCTOBER 25 TO 28

COMMITTEE :

PROPERTIES :

SPECIFICATION

TEST RESULTS :

TEX

SOLIDS (%)

MOISTURE (%)

2130 - 2500

1.14 - 1.40

0.010 - 0.070

	TEX	SOLIDS	MOIST
2401	1.28		0.0
2402	1.27		0.0
2411	1.28		0.0
2397	1.23		0.0
2416	1.21		0.0
2420	1.24		0.0
2452	1.28		0.0
2468	1.25		0.0
2461	1.28		0.0
2471	1.28		0.0
2436	1.29		0.0
2781	1.29		0.0
2482	1.33		0.0
2458	1.35		0.0
2484	1.32		0.0
X	2437.8	1.28	0.0
R	SS	0.14	0.0

OBSERVATIONS :

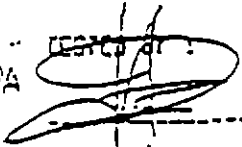
TESTED BY :

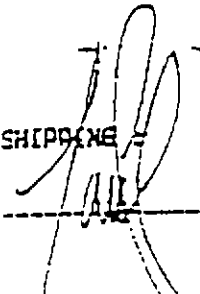
 ALEJANDRO GUTIERREZ

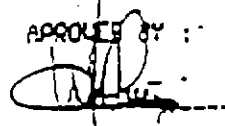
SHIPPING :

APPROVED BY :

 WALTER PAUL PHILIPP P.



CURTIS F. McKNIGHT
 TESTING LABORATORIES, INC.
 Testing and Inspection

7708 E. BRADDA
 TAMPA, FL 33619
 (813) 820-0287

INSPECTION REPORT

MAR 22 1993

Date 2-17-93
 WO# 93-6399
 Customer Fred's Amusements Type of Inspection Visual Testing
 Address 8225 Hudson Applicable Specifications Per ASNT
Gibson Ln, FL 33534 Per STATE OF FL.
 Customer Purchase Order No. Per Customer
 Description and/or Serial No. See below

RESULTS OF INSPECTION

Upon your request Visual Testing was performed on the below mentioned rid. There were no notable indications at line of our examination.

- 1) Space Train - Serial # 1992371
 MANUFACTURER: G.R. Rodina.
- 2) Sizzler - Serial # 73608
 MANUFACTURER: Wisdom
- 3) Airplane Swing - Serial # TMC-001
 MANUFACTURER: Thumberg
- 4) Swing & Sway - Serial # 00617 - Thumberg
- 5) Mini Enterprise - Serial # 201-8498 - Zampeala
- 6) Merry-Go-Round - Serial # 101107151 - Hruschel

Prepared by [Signature] Approved by [Signature] LEUF

Mr. Mike Evans

22 February 1993

Page 2

If you have any questions, please call.

Sincerely yours,

William D. Ashton

WILLIAM D. ASHTON
Professional Engineer



Encl
Affidavit

Copy furnished:
Mr. Jeff Hytecher
604 Main Street
Davenport, Iowa 52803

PRIVACYTOWN.COM

Ashton-Barnes Engineers, Inc.

Engineering Services

319-355-3224
319-355-0321 (Fax)

3432 Jersey Ridge Road
Davenport, Iowa 52807

22 February 1993

Mr. Mike Evans
Kiddie Rides USA
5500 Greenwood Plaza Boulevard
Suite 274
Englewood, Colorado 80111

Re: Structural/Safety Inspection of Train
On Tracks Ride

Dear Mr. Evans:

Per your request on 19 February 1993, I inspected a standard "Train On Tracks" children ride which was set up at your facilities at 604 Main Street in Davenport, Iowa. I was accompanied during the inspection by William Schebler, P.E. We made a visual inspection of the ride's components. We inspected the engine and car bodies, chassis, wheels, car connections, track, and wheel/track interlocking system. The ride was operated by Jeff Hytecher. As stated on the attached affidavit, it is my professional opinion that all Train On Tracks ride components are structurally satisfactory and properly designed for safe operations.

I have discussed the inspection requirements of the State of Florida with Lowell Parrish, Florida Department of Agriculture and Consumer Services. The law requires a visual inspection for metal fatigue be performed by a Level II or III NDT Technician. As I have stated, I do not believe such a test is required to assure a safe Train On Tracks ride since I do not believe metal fatigue is a problem of concern in this application. However, Mr. Parrish cannot waive the requirement and as discussed, you will still have to have a technician with proper certification examine the ride.

604 MAIN STREET
DAVENPORT IA 52803
3801 East 50th Avenue
Denver, Colorado 80216



800-553-8000
(319) 326-6467
FAX (319) 326-6060
1-800-448-6888
(303) 399-7191
Fax (303) 399-8144

WESTERN EXPRESS SPECIFICATIONS

	<u>Length</u>	<u>Width</u>	<u>Height</u>	<u>Weight</u>
Locomotive	7'	3'	5'	270 lbs.
Wagons	6'8"	3'	2'	150 lbs.
Wagons\Roof	6'8"	3'	4'8"	200 lbs.
Track	10'			60 lbs.

Control unit requires standard 110 VAC single phase outlet with 6 controllable speeds.

Track power ranges from 18 VDC to 48 VDC.

Equipped with seat belts.

Entire train locked into track so train cannot derail.

2 year warranty on motors (2 per locomotive).

Drive chain easily accessible for lubrication.

Impact resistant fiberglass construction with heavy sealed gel-cots finish protected against fading from ultra-violet rays.

Each car equipped with exterior lights.

Solid state "space" sound with push button switches the child operates for additional sounds.

Loco capacity 2 children.

Carriage capacity 6 children.

Timer equipped (optional use) with automatic parking at predesignated location.

604 MAIN STREET
DAVENPORT IA 52803
3801 East 50th Avenue
Denver, Colorado 80216



800-553-8000
(319)326-6467
FAX(319)326-6060
1-800-448-6888
(303) 399-7191
Fax (303) 399-8144

TRAIN SPEED

The power to the train is supplied by a transformer that uses 110 volts and reduces the power to 24 volts DC to the track. Track is safe during operation, no shock can occur from track under normal conditions.

The transformer has settings from 1-6, one producing the slowest speed and six making the fastest speed. The adjustments are not for speed but for load factor. The train should never be operated above #2 setting unless the load otherwise determines.

Train ride time should be determined prior to operation, and duly noted. Children have a short attention span. Do not run the train too long. All trains are equipped with seat belts and it is recommended that seat belts be worn by all riders all the time.

Timer should be set for 2 minutes.

604 MAIN STREET
DAVENPORT IOWA 52803
3801 East 50th Avenue
Denver, Colorado 80216



800-553-8000
(319) 326-6467
FAX(319) 326-6060
1-800-448-6888
(303) 399-7191
Fax (303) 399-8144

TRAIN SET-UP

- 1) Lay down track 4 straight and 4 curved track (standard oval).
 - 2) Insert bolts into holes on track making sure track is level, then tighten, leaving one section of the track off.
 - 3) Put the engine and cars on the track where the section of the track has been left off.
 - 4) Be sure engine and cars are on the track properly.
 - 5) Put last section of track in, and insert bolts into holes and tighten down, making sure that all track is level and fits tightly against each other.
 - 6) Connect positive and negative leads to track as marked on track.
 - 7) Plug in homing switch from control box to track. This insures the train will stop at the same spot every time.
 - 8) Plug in control box to 110 VAC and make sure there is plenty of clearance around the track.
 - 9) Turn on control box, set the timer for proper amount of time desired. Recommended time is 2 minutes.
 - 10) Make sure of limited access to the train to prevent uncontrolled access to track.
 - 11) Test train without riders to insure proper set-up and operation..
-
-

604 MAIN STREET
DAVENPORT IOWA 52803
3801 East 50th Avenue
Denver, Colorado 80216

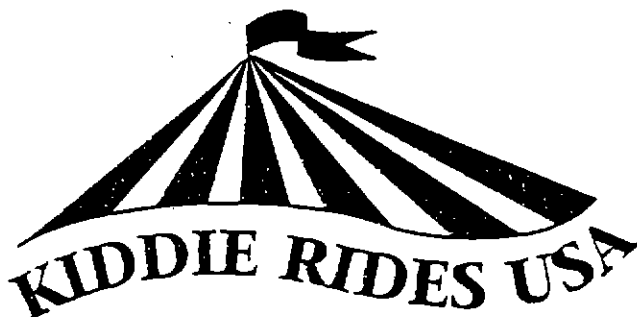

800-553-8000
(319)326-6467
FAX(319)326-6060
1-800-448-6888
(303) 399-7191
Fax (303) 399-8144

TRAIN MAINTENANCE

Each day before you operate the ride take a visual check of the train for mechanical problems.

1. Lift the hood on the locomotive and inspect the chains for looseness. Make sure the chains are well lubricated.
2. Shake the cars, cars should not rock excessively.
3. Check for any wheel wear and replace parts where necessary.
4. Check under carriages for cracks on frame and welds.
5. Check all seal belts and make sure they operate properly.
6. Clean dirt and debris from the cars. (Keep the train clean at all times).
7. Wipe cars off each day with a damp cloth.
8. Wax the train one time per week. (Use Lemon Pledge wax for example). This prevents color fading and keeps your equipment looking new. DO NOT WAX SEATS!
9. Check Track:
 - a. Walk track several times per day.
 - b. Check for general movement, (track should hold a general distance of 3' from any wall or fence).
 - c. Check track bolts each day for tightness, tighten as needed.
 - d. Check electrical connections to track each day, make sure they are clean.
 - e. Check welded areas of track for cracks. Any cracks must be repaired before operation.

NOTE; The above items must be checked prior to each day's operation.

SPACE TRAIN ... On Track for Profit!

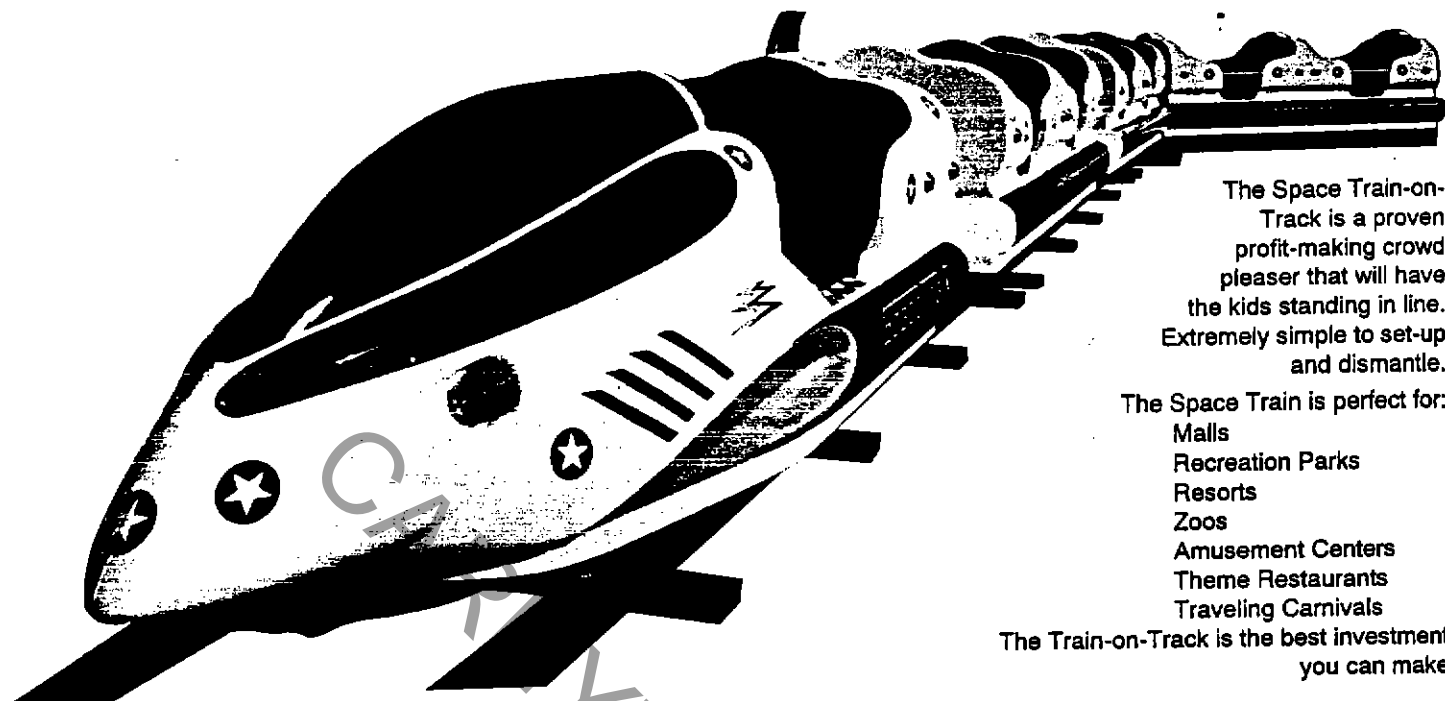

The Space Train-on-Track is a proven profit-making crowd pleaser that will have the kids standing in line. Extremely simple to set-up and dismantle.

The Space Train is perfect for:

Malls
Recreation Parks
Resorts
Zoos
Amusement Centers
Theme Restaurants
Traveling Carnivals

The Train-on-Track is the best investment you can make

ALL ABOARD! FOR PROFITS

Specifications & Features

- Control unit with six variable speeds.
- 110 Volt-single phase
- Track Voltage-24 to 48 volts DC for safety
- Two 4-amp motors in locomotive
- Locomotive holds 2 children
- Locomotive can pull up to 6 wagons
- Each wagon can hold 8 small children or 4 medium-sized children
- Locomotive has controlled sound effects
Locomotives - 220 lbs. - 150 lbs.
Wagons - 105 lbs. - 125 lbs.
Track - 60 lbs.
Rails Width - 1'6" - 1'3"



WESTERN EXPRESS TRAIN

ENGINE	size 206 - 73 - 143	Weight 120 kg.
WAGON	size 176 - 73 - 63	Weight 70 kg.



1-800-448-6888 (303) 721-8910
FAX (303) 771-7567

3801 East 50th Avenue
Denver, Colorado 80216



1-800-448-6888
(303) 399-7191
Fax (303) 399-8144

**WESTERN EXPRESS TRAIN
OPERATIONS AND MAINTENANCE
MANUAL**

CARNIVALTOWN.COM