

KID POWER SYSTEMS



Mfg: Kid Power Systems
Ride: Teen Town F.H.

TOONTOWN FUN HOUSE





**NEW FROM
KID POWER
SYSTEMS:**

**TOON TOWN
Theater
FUN HOUSE**

**Portable Fun House
Trailer Mounted**

TOON TOWN Theater FUN HOUSE, the **ULTIMATE** walk-thru design for your modern **KIDDIE-LAND** line up. Thrilling mechanical and visual action brings adventure to the whole family. A special integrated close circuit color camera allows patrons to interact with their favorite cartoon characters up on the big screen.

TOON TOWN FUN HOUSE attracts maximum attention due to its sculpted facade and abundant architectural details throughout, lending a new level of excitement to your midway. Quality construction includes double-fold end wings, aluminum decks/platforms, and it comes complete with a state of the art Fire/Safety system. This unit not only has two unique outer marquees, which are neon lit, but eight different exciting internal attractions as well. Expand your **KIDDIE-LAND** today, with the all new **TOON TOWN Theater FUN HOUSE!**

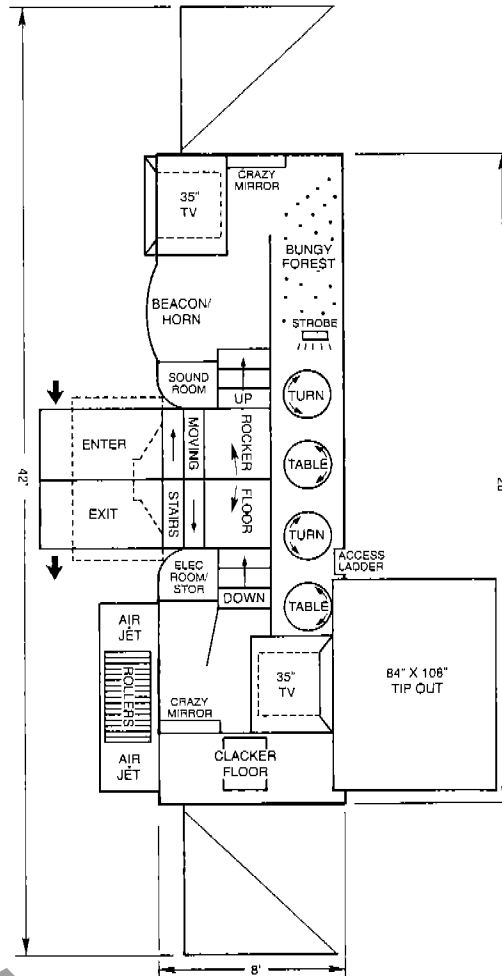
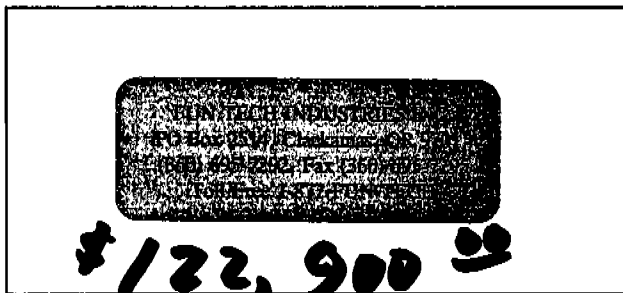

STANDARD SPECIFICATIONS

- 28' Custom semi-trailer air brakes (spring)
- Single axle, air ride suspension
- Steel belted radial tires
- 12 VDC Automatic safety interlock system
- 2 ea. 35" Mitsubishi television
- 1 ea. 2000 Watt inverter for 'clean' power
- Sound console with VCR, amplifier, crossover, and equalizer
- 2 ea. Large speakers with bass
- 1 ea. Closed circuit color camera with interface

STANDARD ELEMENTS

MOTORIZED DEVICES

- 2 ea. Moving stairs (back and forth)
- Rocker floor
- 4 ea. Turntables
- 1 ea. Vibrating floor section
- 1 ea. Air compressor
- 2 ea. Funny mirrors with rope lights
- Bungy forest
- 1 ea. Strobe light
- Rollers
- 2 ea. Marquees/neon lit (fiberglass)
- 12 VDC Winch to raise back floor
- Powder coated handrails
- All steel construction
- Unlimited capacity
- 1½ hours up; 1½ hours down 2 men

Manufacturers of

**JUNGLE OF FUN • KID POWER Play Area • GHOST PIRATES Dark Ride
MUSIC VIDEO Fun House**

SET-UP PROCEDURE

REQ'D. TOOLS: HAMMER
6' STEP LADDER
LEVEL
7/16" NUT DRIVER

REQ'D. LUBRICANTS: 90 WT. GEAR OIL
WD-40
NEVER SEIZE
BEARING GREASE
30 WT. NON-DETERGENT GEAR OIL
1 GAL. DISTILLED WATER

SET-UP

- STEP 1)** LOCATING TRL. ON THE MIDWAY: CENTER THE TRL. 7'-6" BACK FROM WALKWAY LINE OF ITS DESIGNATED SPACE.
DROP TRAILER, BLOCK PROPERLY AND LEVEL IN BOTH DIRECTIONS USING THE 4 LEVELING JACKS.
- STEP 2)** REMOVE THE ENTRANCE HANDRAILS FROM THE BACKSIDE OF THE ENTRANCE/EXIT PLATFORM AND SET ASIDE. UNPIN AND LOWER ENT/EXIT RAMP. SET LEVEL ON ONE 2 X 4 (MIN). AT EACH CORNER.
INSERT DECK HANDRAILS (3 EA.). THEY ARE MARKED AS TO RIGHT LEFT AND CENTER. CENTER RAIL IS RACKED IN FRONT OF PLASTIC BLOCK WALL INSIDE OF THE TRAILER.
- STEP 3)** ROLL OUT OVERHEAD MARQUEE. FROM INSIDE OF BACK HALLWAY.
UNLATCH MARQUEE AND PUSH FROM THE CENTER ALL THE WAY UNTIL IT HITS THE PROVIDED STOP.
- STEP 4)** LOWER FRONT BALCONY. WITH USE OF STEP LADDER, UNLATCH BALCONY (2 MEN REQD.) AND LOWER 90*. PIN HANDRAIL AT LOWER BACK CORNERS USING 2 EA. 5/16" SNAPPER PINS. SNAP ON BALLY CLOTH.
- STEP 5)** ERECTING BACK TIP OUT. ASSUME 12 VDC BATTERIES ARE UP AND CHARGED. REMOVE OUTER VERTICAL BRACE AND SWING OUT

THE TWO REAR SIDE WALLS. FROM INSIDE THE TRAILER BACK CROSS HALLWAY ENGAGE WINCH CONTROLS AND LOWER BACK FLOOR (ASSUME WINCH CABLE IS HOOKED PROPERLY TO BACK FLOOR AND CABLE IS RIDING IN V-GROOVE GUIDE WHEEL). LOCK FLOOR INTO SIDE WALLS. UNHOOK CABLE AND RE-WIND. FROM INSIDE REAR HALLWAY, HAND OUT TIP-OUT FLOOR SUPPORT JACKSTAND AND THE 2 ADJUSTABLE JACKSTANDS. INSERT PEGS INTO CORRESPONDING HOLES ON UNDERSIDE OF FLOOR, ADJUST THIS ASSEMBLY PLUMB AND SECURE. FOLD UP REAR WALL AND PIN AT CORNERS.

STEP 6) ERECT UPPER ROOF PANELS OF FUN HOUSE. BEFORE THESE 5 PANELS CAN BE RAISED, THE FIBERGLASS MARQUEE MUST BE INSTALLED. IT IS LOCATED IN THE BACK CROSS HALLWAY AND CAN BE HANDED UP TO THE ROOF AND HUNG ON THE CORRESPONDING ANGLE BRACKET LOCATED ON THE CENTER ROOF PANEL.
UNPIN AND RAISE THE END PANELS FIRST. THERE ARE TWO PANELS AT EITHER END OF TRAILER. THEY LOCK TOGETHER. 5/16" SNAPPER PINS ARE REQUIRED.
RAISE THE CENTER ROOF PANEL AFTER THE FIBERGLASS MARQUEE HAS BEEN PUT INTO PLACE. SECURE THE CENTER PANEL WITH THE BRACE ARMS NUMBERED 1 AND 2.

PLUG IN THE MALE/FEMALE TWIST LOCK PINS ON THE UPPER CHASE LIGHTS (IF REQUIRED) HAND UP THE 4 OVERHEAD QUARTZ FIXTURES.

THESE ARE LOCATED IN THE LOWER STORAGE AREAS ON THE PASSENGER SIDE OF THE TRAILER. (USE EM505 OR 545 KEY) THESE LIGHT BRACKETS (RED) MUST BE INSTALLED AS PER RIGHTS AND LEFTS AS PER THE FLAG SHAFT ON THE LIGHT BRKTS.

UNTIE THE ROOF TOP OVER THE REAR TIP OUT. INSTALL AND PIN THE 2 TIP OUT ROOF SUPPORTS (INTERCHANGEABLE). SPREAD THE TENT TOP OVER THE TIP OUT AND PROCEED TO TIE IT OFF AROUND THE PERIMETER WITH THE HOOKS AND SNAPS PROVIDED.

STEP 7) FOLD OUT THE END WINGS. (EITHER END) FRONT OF TRAILER: UNPIN THE VERY MOST FRONT WING ON THE NOSE OF THE TRAILER (USE LADDER) AND FOLD DOWN 180*. UNPIN DOUBLE FOLD END WINGS AND SLOWLY FOLD OUT SPREADING OPEN ALL PANELS AND INTERNAL SUPPORT FRAMES. NOTE THAT THE

FIRST PANEL FOLDED DOWN MUST BE ALLOWED TO SWING INTO POSITION BETWEEN THE GLAD HANDS. INSTALL THE 2 SHORT BRACE ARMS NUMBERED '1' AND '2'. THIS WILL LOCK THE WHOLE ASSEMBLY INTO PLACE.

NOW THAT THIS STRUCTURE IS OUT AND OPEN, SLIDE OPEN THE ALUMINUM ACCESS PANEL. REMOVE THE 2 PANELS THAT ARE STORED HERE. THE LONG PANEL INSERTS AND PINS IN UNDER THE GOOSE NECK AREA AT THREE POINTS USING HAIRPIN COTTER KEYS. THE SMALLER PANEL PINS IN FROM UNDERNEATH THE FRONT WING USING 2 COTTERS. INSERT THE THREE 9/16 PINS PROVIDED TO LOCK ALL THESE PANELS TOGETHER. CLOSE AND PIN SLIDING ACCESS DOOR W/ R-KEY.

STEP 8) FOLD OUT THE REAR END WINGS. UNPIN AND SWING OUT INTO ITS DOUBLE 90° POSITION. INSERT THE SHORT BRACES NUMBERED '3' AND '4'. SNAP ON LOWER EDGE BALLY CLOTH.

STEP 9) INSTALL POST AND ROPES IN BACK ROOM CREATING PATH AROUND THE NEARBY 35" TV SET. ANCHOR POSTS TO FLOOR WITH THE PROVIDED ½-13 HARDWARE T-HANDLE ASSY.

TOON TOWN START-UP INSTRUCTIONS

- 1) REMOVE COVERS FROM BOTH TV SETS. REMOVE CAP FROM COLOR TV CAMERA.
- 2) TURN ON AND ENGAGE SYSTEMS:
 - A) WITH ALL APPROPRIATE CIRCUIT BREAKERS (ELEC. ROOM) **OFF:**
 - B) ASSUME MAIN AC LINE HOT, ENGAGE MAIN BREAKER (BELOW)
 - C) NOW TURN ON ALL APPROPRIATE BREAKERS
 - D) FROM 'SOUND ROOM' TURN ON:
 - 1) TURN ON KEY START / PUSH GREEN BUTTON
 - 2) BREAKERS FOR TV/SOUND CONSOLE
 - 3) POWER UP VCR AND INSERT VCR TAPE, PUSH PLAY
 - 4) TURN ON AMPLIFIER, ADJUST VOLUME/ RIGHT AND LEFTNOTE: NO OTHER SOUND ADJUSTMENTS ARE NECESSARY

- 5) TURN ON BOTHS TV, MANUALLY OR WITH A REMOTE CONTROL. LOWER VOLUME ON BOTH TV'S TO '0'.
 - 6) ENGAGE CAMERA/CONVERTER. SEE INSTRUCTIONS IN 'CAMERA ROOM'.
- 3) RESET SAFETY SYSTEM IF NECESSARY. SEE ENCLOSED SAFETY SYSTEM OPERATORS GUIDE.

TOON TOWN- RECOMMENDED MAINTENANCE

DAILY:

- 1) VISUALLY INSPECT ALL ELECTRICAL CONNECTIONS (PLUGS, WIRES ETC.) DAILY.
- 2) INSPECT ALL PINS, KEYS, TABS, KEEPS ROUTINELY.
- 3) INSPECT ALL MOTORIZED DRIVE ARMS FOR TIGHTNESS AND ALIGNMENT. CHECK SET SCREWS WITH ALLEN WRENCH.
- 4) CHECK ALL BLOCKING AND ANY HARDWARE FASTNERS THROUGHOUT.
- 5) DRAIN WATER FROM AIR COMPRESSOR NITELY/ DAILY
- 6) SWEEP FLOORS DAILY AND KEEP FROM DEBRIS
- 7) CLEAN BOTH MIRRORS / STARS DAILY WITH PROPER PLASTIC CLEANER AND POLISH. (DO NOT USE WINDEX OR PAPER TOWELS).
- 8) ONLY CLEAN TV MONITOR SCREENS WITH THE POWER OFF.

WEEKLY:

- 1) CHECK OIL IN AIR COMPRESSOR. USE NON-DETERGENT OIL ONLY. DO NOT OVER FILL.
- 2) REPLACE ALL LIGHT BULBS AS NECESSARY. DO NOT LEAVE

A LIGHT SOCKET EMPTY. (VSV 090 SERIES) 12 WATT. 130 VOLT

- 3) WATER LEVEL IN THE TWO 6 VOLT BATTERIES MUST BE CHECKED AND KEPT FULL. USE DISTILLED WATER ONLY. ALL BATTERY CONNECTIONS MUST BE KEPT TIGHT AND CLEAN. ACCESS TO BATTERY CAN BE FROM THE REAR OR THROUGH THE FRONT ACCESS PANEL USING A 7/16" WRENCH TO REMOVE ACCESS PANEL.
- 4) WITH WD-40 SPRAY, SPRAY ALL HINGES BOTH VERTICAL AND HORIZONTAL AND ALL SLIDING PINS. WIPE SURFACE CLEAN AFTER SPRAYING.

TOON TOWN TEAR-DOWN PROCEDURE

- 1) UNTIE, PULL UP AND NEATLY FOLD AND TIE DOWN SECURELY THE BACK TIP OUT TENT TOP. UNPIN AND REMOVE THE TWO ROOF RAFTERS. THEY STORE IN BACK HALLWAY FLOOR.
- 2) FOLD DOWN ROOF PANELS. UNPLUG AND REMOVE OVERHEAD ROOF LIGHT FIXTURES/FLAGS. HAND DOWN AND RACK IN REAR, LOWER POSSUM BELLY. LOWER DOWN CENTER WING FIRST. UNPLUG AND REMOVE CENTER MARQUEE. HAND DOWN AND HANG IN REAR HALLWAY. MAKE CERTAIN TO PIN THIS WING TO THE ROOF. UNPIN AND FOLD DOWN EITHER END WING PANELS. ONCE DOWN, PIN PROPERLY.
- 3) PUT AWAY REAR TIP-OUT. UNPIN AND FOLD DOWN BACK WALL. RELEASE FLOOR JACKS AND REMOVE FLOOR SUPPORT JACKSTAND. HAND UP AND STORE IN BACK HALLWAY. WIND OUT CABLE AND HOOK TO BRKT. ON FLOOR. WINCH UP FLOOR BEING CAREFUL NOT TO SCRAPE SURFACE OF THE SIDE WALLS. FOLD IN SIDE WALLS AND PIN WITH THE 1" PIPE RETAINING MEMBER AND PIN (IF APPLICABLE) COVER TV MONITOR WITH BLACK VINYL TARP BEFORE RAISING FLOOR.

- 4) REMOVE/UNSNAP BOTH LOWER BALLY CLOTHS. TURN OFF ALL CIRCUIT BREAKERS AND THE MAIN DISCONNECT. CLOSE AND LOCK DOOR TO THE ELECTRICAL ROOM. UNPIN AND FOLD UP THE LOWER BALCONY. WITH AID OF LADDER SLIDE PIN AND LOCK FOR TRANSPORT.
- 5) FOLD IN THE REAR DOUBLE FOLD END WINGS. REMOVE BRACE ARMS '3' AND '4', AND HANG VERTICALLY. FOLD IN END WING AND THEN THE FRONT END WING. PIN PROPERLY.
- 6) FOLD IN FRONT DOUBLE END WING SYSTEM. UNPIN AND SLIDE OPEN THE HALLWAY ACCESS PANEL. REMOVE AND INSERT THE GOOSE NECK PANEL AND THE LOWER END WING. SLIDE ACCESS PANEL SHUT AND PIN FOR TRANSPORT. FOLD END WING SYSTEM AND PIN.
- 7) CRANK UP REAR JACKSTANDS AND BLOCK TIRES. DISCONNECT THE MAIN LEAD AND ROLL UP. CLOSE AND LOCK ALL DOORS INSIDE AND OUT.
- 8) ROLL IN OVERHEAD MARQUEE AND LATCH. REMOVE ALL 3 RAMP HANDRAILS. RACK LONG CENTER RAIL IN RACK PROVIDED IN FRONT OF GLASS BLOCK WALL.
- 9) RAISE UP AND PIN THE LARGE ENTRANCE RAMP AND PIN ON BOTH SIDES. INSERT THE 2 SIDE ENTRANCE HANDRAILS INTO THE POCKETS LOCATED ON THE BACK SIDE OF THE ENTRANCE RAMP.
- 10) DRAIN WATER TANK IF APPLICABLE.

OPERATING CONDITIONS

THIS ATTRACTION MAY BE OPERATED UNDER RAINY AND WINDY CONDITIONS. THE UNIT DOES NOT NEED TO BE IN BALANCE OR BALANCED.

PATRON SAFETY

THIS WALK THRU ATTRACTION IS APPROPRIATE FOR CHILDREN 42" TALL OR TALLER. ADULTS MAY ENTER THE UNIT WITH THE CHILDREN OR ALONE. PHYSICALLY AND/OR MENTALLY HANDICAPPED PERSONS ARE PERMITTED TO ENTER WITH A COMPANION. PLEASE KEEP IN MIND THAT

SOME 'TOON TOWN THEATRES' ARE EQUIPPED WITH STROBE LIGHTS AND THEREFORE PREGNANT WOMEN OR PERSONS WITH A HEART CONDITION MAY NOT PARTICIPATE. IT IS RECOMMENDED THAT BARE-FEET, SANDALS OR OPEN TOED SHOES ARE NOT PERMITTED. PATRONS MAY ENTER WITHOUT ATTENDANT ASSISTANCE.

IN A SHUT DOWN EMERGENCY, TURN OFF ALL ELEMENTS VIA THE "MAIN POWER OFF" RED BUTTON WHICH IS LOCATED ON THE LEFT SIDE OF THE MAIN ENTRANCE RAMP.

©1998 FUN TECH INDUSTRIES INC.

CARNY TOWN.COM

SOUND AND VIDEO SYSTEM INSTRUCTIONS

Turn on procedure:

- 1 Battery charger breakers.
- 2 Trace AC emulator and breaker switches above the unit.
- 3 Make sure Amp, EQ, Power strip and VCR are now lit.
- 4 Turn down Front and Rear volume on Amp.

- 5 Front 35" TV and set to input Ch#3 to view standard cartoon.
Note: Use AUX1 input to view cartoon and camera together.

- 6 Turn on video switcher in Camera Room.
- 7 Turn on 9" monitor and set to input #1 if not set already.
- 8 Make sure the Red power LED is lit on back of camera.

- 9 Rear 35" TV (it's input should set to video 1 SVHS).
- 10 The spotlights can now be turned on with the breaker switch in the main power room.

Important note: If this is the first time you are attempting to operate this system please view the video tape we have included on the operation of the video switcher. Please insert tape now press play and turn up the volume for the TV that you will be viewing this tape from. Watch the entire tape and review as many times as necessary. As you learn more about the switcher you will also be able to view it on the 9" monitor in the camera room while you actually make the changes to the switcher console. This will take you thru it step by step, and will function properly if the Camera lens is adjusted properly.

Camera Lens and Lighting adjustment:

- 1 The front of lens turns to adjust focus of person.
- 2 The middle of lens turns to adjust light level & color balance. Adjust for brightest color and picture.
- 3 CAUTION: Do not adjust the large ring closest to camera. This is for master focus and has been preset at the factory.
- 4 To view your changes to the lens press "B" on the upper row of keys then press play of the video switcher to view on the 35" TV in the room while adjusting or viewing the monitor.
- 5 After you have adjusted the camera for the best picture then return to viewing the 9" monitor, and turn the power off on the Video switcher and then back on again to clear the settings and return it to its factory setup.
NOTE: You may also do this anytime you make a mistake during step six, to restore original settings and reset MX1 Mixer.

Now follow the video tape instructions for Croma Key setup.

- 6 To set, Start VCR! Press CromaKey, move cursor, press OK, (repeat as necessary) when complete press Play to mix all.

For technical support call SWEET SOUND at (503) 293-9466

POWER DISTRIBUTION FOR
TOON TOWN FH-28
12/98

DROP CORD
220 VAC
SINGLE PHASE

