

MFG: IWORKS  
P/N: MOTION MASTER THEATER

### Motion Base Lubrication

1. Drive Bar Bearings
2. Vertical Plastic Alignment
3. Vertical Steel Alignment
4. Horizontal Main Tube Bearing Surface
5. Slide Bar Bearing
6. Stay Bar Bearing
7. Hydraulic Cylinder Mount
8. Drive Bar Bearings

## Motion Base Inspection

1. **Tilt Arm Assembly. Manually move seat in Pitch directions, forward and reverse, and check for excessive play.**
2. **Drive Bar Assembly. Manually move seat in Roll directions, left and right, and check for excessive play.**
3. **Any indication of Hydraulic Leaks.**
4. **Cylinder Rod Clevis Back Off.**
5. **Hydraulic Cylinder Hose Abrasions.**
6. **Electronic Cable Abrasions.**
7. **Seat Belt Strap Abrasions.**



## Bolt Torque

### Inspect and Adjust Accordingly

1.       **Seat Mount Bolts.   (30 ft. lbs.)**
2.       **Main Tube Cap Nut. (70 ft. lbs.)**
3.       **Slide Bar Bearing Bolts. (30 ft. lbs.)**
4.       **Hydraulic Cylinder Mount Bolts.  
(45 ft. lbs.)**
5.       **Seat Pivot Bolts.   (10 ft. lbs.)**  
          **NOTE: Cotter Pin MUST be in place.**
6.       **Steel Roller Bearings (Vertical  
Alignment).   (175 ft. lbs.)**

### ACCUMULATOR PRESSURE:

**Maintain 1000 PSI in ALL Accumulators.**

# Seat Row Repair Chart

Date \_\_\_\_\_

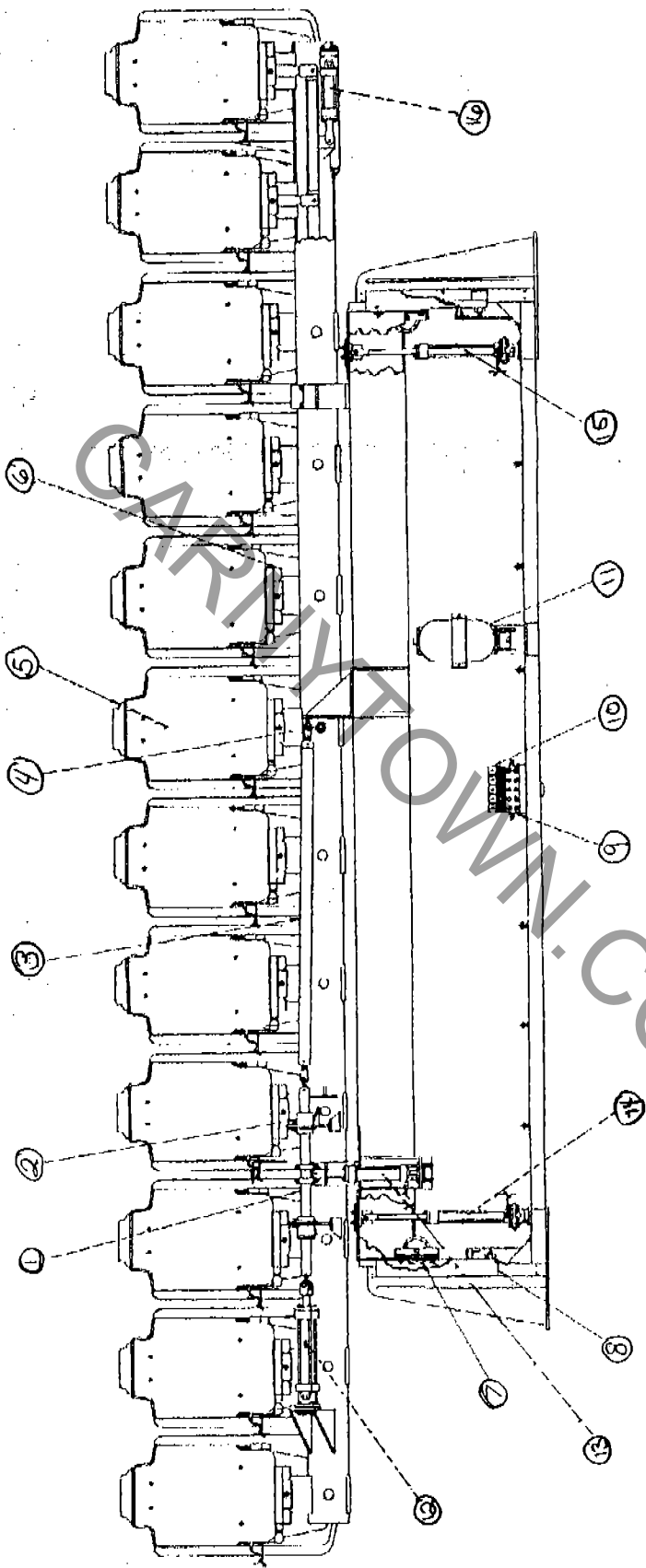

Row # \_\_\_\_\_

Problem area \_\_\_\_\_

Description of Repair \_\_\_\_\_

Parts Used \_\_\_\_\_

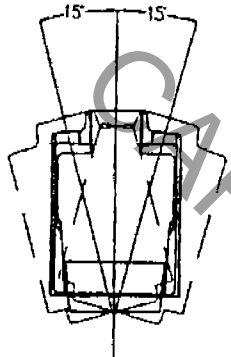
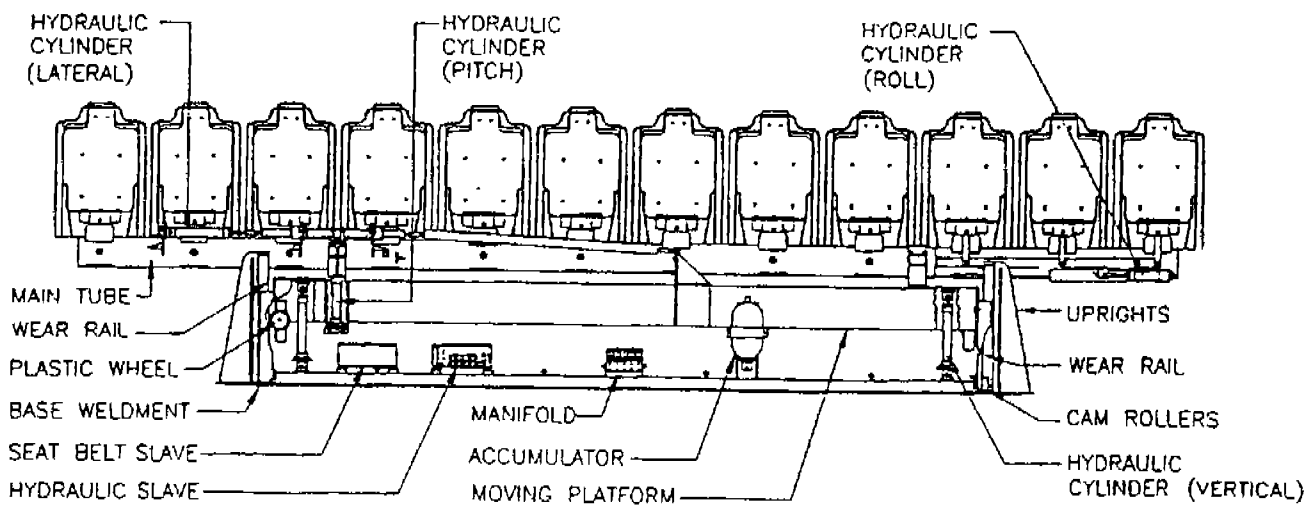

**ROLL MOTION**  
(+15.0 DEG. / -15.0 DEG.)

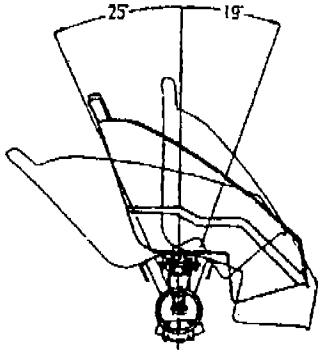

**PITCH MOTION**  
(+19.0 DEG. / -25.0 DEG.)

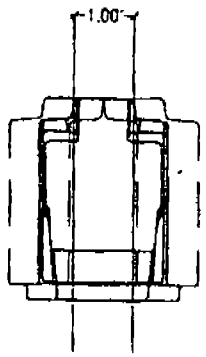

**LATERAL MOTION**  
(+6.0 INCHES / -6.0 INCHES)

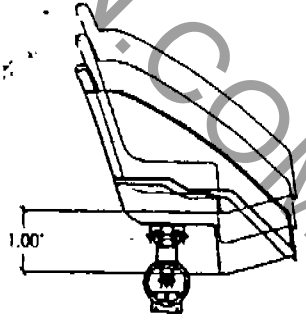

**VERTICAL MOTION**  
(+6.0 INCHES / -8.0 INCHES)

**Figure 1-1. Motion System With Seat Movement**

# **GUINNESS WORLD RECORDS EXPERIENCE** **OPERATING PROCEDURES**

## **SECTION 1 – OPENING PROCEDURES**

### **Hydraulics**

1. Approach hydraulic panel
  - a. Turn on cooling fan
  - b. Turn on circulation pump
  - c. Turn on package
  - d. Turn on pump 1 and 2 (Mondays, Thursdays and Sundays ONLY)
  - e. Turn on pump 1 and 3 (Tuesdays and Fridays ONLY)
  - f. Turn on pump 2 and 3 (Wednesdays and Saturdays ONLY)
2. Ensure all switches on front lower panel of projector are in “on” position.
3. Turn on switch to ignite bulb on projector.
4. Turn on monitor in projection room.
5. Starting from far right cabinet, ensure that all amplifiers are on.
6. Turn on CD player.
7. At center cabinet, ensure all systems are turned on.

## **SECTION 2 – LOADING AND RUNNING A SHOW**

### **To Load a Show**

1. Press F-1 on keyboard.
2. Go to “list” and press Enter.
3. Scroll down to “show” and load file name “Guinness”, and press Enter.

### **To Run a Show**

1. Ensure show is loaded.
2. Press “Alt R” and show will begin to run.

### **SECTION 3 – OPERATING REMOTE STATION**

#### **To Run a Show**

1. To Load a show, press “load show” icon and load file name “Guinness”.
2. To start a show, press and hold for a few seconds, the “start” icon.

#### **In Case of Emergency**

1. To stop a show for emergency [if you need to stop ride at remote station]

If someone is sick  
If someone faints  
If someone gets out of their seat

Stop ride by pressing and holding for a few seconds, the “pause” icon.

### **SECTION 4 – IN CASE OF EMERGENCY IN THEATER**

In case of an emergency [if you need to stop the ride]

If someone is sick  
If someone faints  
If someone gets out of their seat

Stop ride by pressing any of the emergency stop buttons located in the theater.

### **SECTION 5 – IN CASE OF EMERGENCY WITH HYDRAULICS**

In case of emergency [if you need to shut off hydraulics]

If you see hydraulic fluid spraying as a result of a major leak  
If you see a visible puddle of hydraulic fluid on the floor

Immediately shut off the pumps.

### **SECTION 6 – THINGS TO LOOK FOR**

#### **During the Ride**

During operation of the ride, you should look out for the following:

1. Worn seat belts
2. Leaks of any type

3. Unusual noises (i.e. creaking, banging, grinding, etc, in the theater) and/or (squeaking, grinding, excess noise in the projection room).
4. Loose articles left behind by customers

Report any findings to a supervisor.

**SECTION 7 – CLOSING PROCEDURES**

**All Areas of Theater**

1. Turn off hydraulic pumps
2. Turn off circulation pump
3. Turn off package
4. Turn off cooling fan
5. Turn off bulb on projector
6. Turn off amplifiers and all audio equipment in the right cabinet
7. Turn off CD player
8. Turn off monitor
9. Place hand on top of projector. If it is not too hot to touch, turn off fan on front of projector. Switches are labeled.

\*\*\*\*\*

I have been trained on, and properly understand the above Moving Theater.

\_\_\_\_\_  
Date

\_\_\_\_\_  
Name (Print)

\_\_\_\_\_  
Supervisor Name (Print)

\_\_\_\_\_  
Signature

\_\_\_\_\_  
Supervisor Signature